

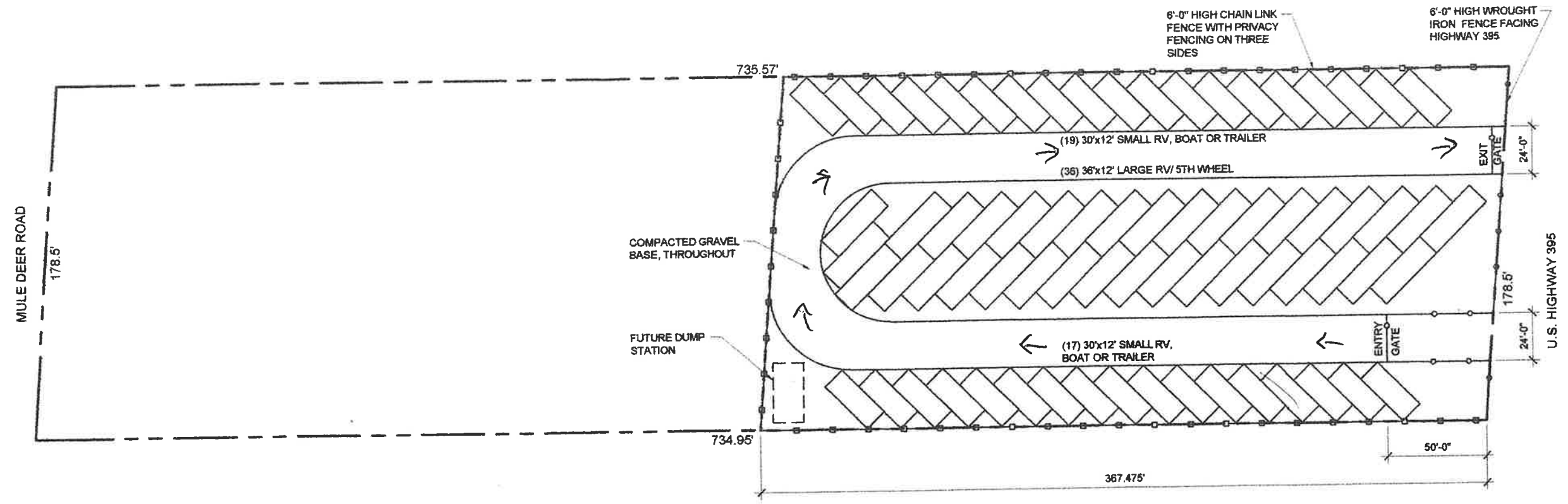

- ① Customers will access parking area at the entry/exit gates through a coded lock box with key inside to unlock gates.
- ② There will be 72 parking spaces: (36) 30'x12' and (36) 36'x12'



<p>Owner: Victor Carter          Address: 2680 Plumbago Ct.          Rocklin, CA 95766          Telephone Number: 209-923-2711</p>	<p><b>VICTOR CARTER</b>          107227 HIGHWAY 395          COLEVILLE, CA 96107          APN: 002-370-005-000</p>		<p><b>SITE PLAN</b></p> <p>Scale: 1" = 50'-0"          Date: May 27, 2023          Sheet: 1 of 1</p>
--	--	---	--