

Mono County Community Development Department

PO Box 347
Mammoth Lakes, CA 93546
760.924.1800, fax 924.1801
commdev@mono.ca.gov

Planning Division

PO Box 8
Bridgeport, CA 93517
760.932.5420, fax 932.5431
www.monocounty.ca.gov

DIRECTOR REVIEW APPLICATION

APPLICATION # _____	FEE \$ _____
DATE RECEIVED _____	RECEIVED BY _____
RECEIPT # _____	CHECK # _____ (NO CASH)

APPLICANT/AGENT Granite Construction Company / Tim Findley

ADDRESS PO Box 5127 CITY/STATE/ZIP Bakersfield / CA / 93388

TELEPHONE (661) 399-3361 E-MAIL timothy.findley@gcinc.com

OWNER, if other than applicant Los Angeles Depart of Water and Power

ADDRESS PO Box 51111 CITY/STATE/ZIP Las Angeles /CA / 90051

TELEPHONE (800) 342-5397 E-MAIL _____

DESCRIPTION OF PROPERTY:

Assessor's Parcel # 021-130-037 General Plan Land Use Designation _____

PROPOSED USE: Applicant(s) should describe the proposed project in detail, using additional sheets if necessary. Note: An incomplete or inadequate project description may delay project processing.

See Attached Letter

I CERTIFY UNDER PENALTY OF PERJURY THAT I am: legal owner(s) of the subject property (all individual owners must sign as their names appear on the deed to the land), corporate officer(s) empowered to sign for the corporation, or owner's legal agent having Power of Attorney for this action (a notarized "Power of Attorney" document must accompany the application form), AND THAT THE FOREGOING IS TRUE AND CORRECT.

Signature 

Signature _____ Date 9/5/18

RECEIVED
SEP 13 2018

Mono County
Community Development



Tim Findley, Plant Engineer
Granite Construction Company
PO Box 5127
Bakersfield, CA 93388
Office: 661-399-3361
Cell: 661-331-5792
Fax: 661-399-7160
timothy.findley@gcinc.com

8/28/18

Nick Cross
County of Mono
P.O. Box 347
Mammoth Lakes, CA 93546
Enclosure: Director Review Application
check 03384991

Dear Mr. Cross,

In an email dated August 9, 2018 to William Taylor with Granite Construction, you directed him to submit a Director Review application for a minor modification to the Reclamation Plan for Granite's 120 E Pit. Enclosed with this letter is that Director Review Application with pertinent information filled in. Since the project design has not changed, no new plot plans were included with the application.

Application requests the following changes to Reclamation Plan 34-99-01, which was adopted on Feb. 16, 1999:

1. Section 3.1.0 GENERAL DESCRIPTION, revise proposed termination date of the operation to 2073.
2. Section 3.4.0 TOPSOIL HANDLING be revised to remove the sentence "Topsoil and growth media will be stockpiled within the mined out area, below the line of site from Highways 120 and 395.", and;
3. Section 3.5.0 OVERBURDEN HANDLING be revised to remove the sentence "Overburden will be stockpiled in mined out areas below the line of site of Highways 120 and 395."

Should you require any additional information, please feel free to contact me.

Sincerely,

Tim Findley, Plant Engineer

Granite Construction Company

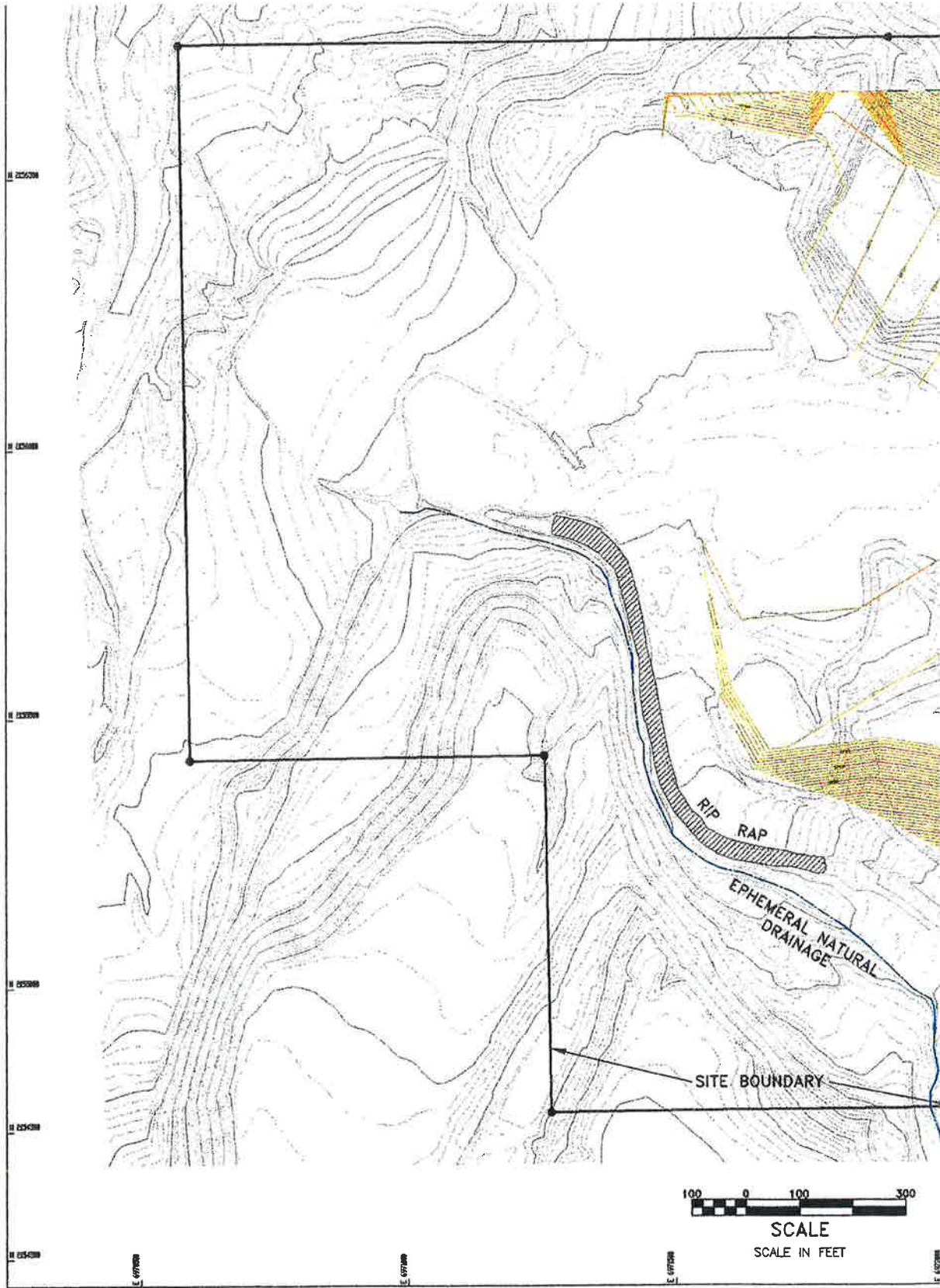



MONO ROCK LEE VINING MINE EXPANSION LEE VINING, CALIFORNIA POST RECLAMATION SITE MAP	TEAM ENGINEERING & MANAGEMENT BISHOP, CALIFORNIA	DRAWING PREPARED BY: DENIO & ASSOCIATES ENGINEERING BISHOP, CALIFORNIA 760 875-8812	SCALE: NO SCALE DATE: 12/31/98 DRAWN BY: DAN CHK'D BY: WJP	REVISIONS <table border="1"> <tr><td> </td><td> </td><td> </td></tr> <tr><td> </td><td> </td><td> </td></tr> <tr><td> </td><td> </td><td> </td></tr> <tr><td> </td><td> </td><td> </td></tr> </table>												
FIGURE 7																