

MONO CITY ROADS AND BENTON CROSSING ROAD (PHASE 1) ROAD MAINTENANCE PROJECT

PROJECT NO. 9304-9305

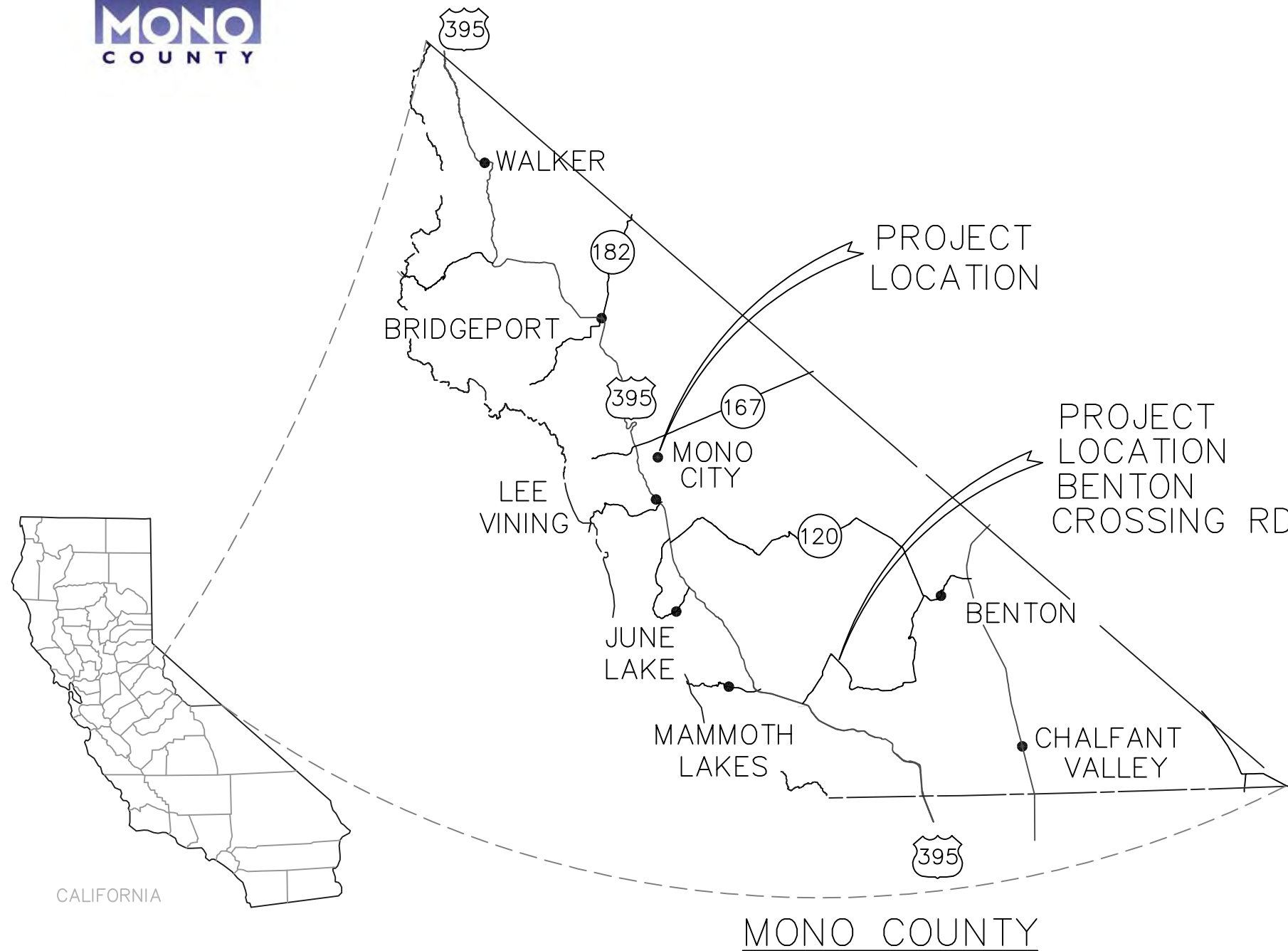

EXP. 6/30/2021
SIGNED: 06/24/2019



PLAN SET INDEX

- T1: TITLE SHEET AND PROJECT LOCATION MAP
- T2: GENERAL CONSTRUCTION NOTES

BASE BID A:

- A1: MONO CITY ROADS SHEET INDEX, TYPICAL SECTION, & DETAILS
- A2: EAST MONO LAKE DRIVE STA 1+03.49 TO STA 8+50
- A3: EAST MONO LAKE DRIVE STA 8+50 TO 16+50
- A4: EAST MONO LAKE DRIVE STA 16+50 TO 25+00
- A5: EAST MONO LAKE DRIVE STA 25+00 TO 33+50
- A6: BLUE LAKE WAY STA 0+00 TO STA 2+61.12
- A6: EAST MONO LAKE DRIVE STA 33+50 TO 42+00
- A7: EAST MONO LAKE DRIVE STA 42+00 TO 50+50
- A7: PEELER LAKE DRIVE STA 0+00 TO 5+50
- A8: EAST MONO LAKE DRIVE STA 50+50 TO 59+00
- A8: PEELER LAKE DRIVE STA 5+50 TO STA 14+00
- A8: SILVER LAKE WAY STA 0+00 TO 4+68
- A9: EAST MONO LAKE DR STA 59+00 TO 65+07
- A9: PEELER LAKE DR STA 14+00 TO 22+40
- A10: TWIN LAKES DRIVE STA 0+00 TO STA 8+19
- A10: GREEN LAKE COURT STA 0+00 T STA 2+27
- A10: LAKE HELEN COURT STA 0+00 TO STA 1+69

BASE BID B:

- B1: BENTON CROSSING ROAD SHEET INDEX AND TYPICAL SECTIONS
- B2: BENTON CROSSING ROAD STA 11+66 TO STA 67+00
- B3: BENTON CROSSING ROAD STA 67+00 TO STA 125+00
- B4: BENTON CROSSING ROAD STA 125+00 TO STA 183+00
- B5: BENTON CROSSING ROAD STA 183+00 TO STA 250+00
- B6: BENTON CROSSING ROAD STA 250+00 TO STA 260+00
- B10: BENTON CROSSING ROAD PAINT STRIPING PLAN
- B11: BENTON CROSSING ROAD SIGN PLAN

BID ALTERNATE C:

- B7: BENTON CROSSING ROAD STA 260+00 TO STA 337+00
- B8: BENTON CROSSING ROAD STA 337+00 TO STA 370+00
- B9: BENTON CROSSING ROAD STA 370+00 TO STA 398+44
- B10: BENTON CROSSING ROAD PAINT STRIPING PLAN
- B11: BENTON CROSSING ROAD SIGN PLAN

MONO COUNTY PUBLIC WORKS DEPARTMENT	
Revision	Date
Rev.#	Date
Drawing Date: 06/24/2019	Prepared By: CAS
	Checked By: GRH
MONO CITY ROADS & BENTON CROSSING ROAD ROAD MAINTENANCE PROJECT (NO. 9304-9305)	
TITLE SHEET PROJECT LOCATION MAP & PLAN SET INDEX	

SHEET
T1

GENERAL CONSTRUCTION AND SITEWORK SPECIFICATIONS

GENERAL:

1. ALL WORK SHALL CONFORM TO THESE PLANS, PROJECT SPECIFICATIONS, MONO COUNTY ORDINANCES AND STANDARDS, AND "A POLICY ON GEOMETRIC DESIGN OF HIGHWAYS AND STREETS" (2018 GREEN BOOK) ISSUED BY THE AMERICAN ASSOCIATION OF STATE HIGHWAY AND TRANSPORTATION OFFICIALS (AASHTO). RELEVANT PLAN DETAILS AND SPECIFICATIONS ARE ADOPTED FROM CALIFORNIA DEPARTMENT OF TRANSPORTATION (CALTRANS) STANDARD SPECIFICATIONS AND STANDARD PLANS (2015 EDITION). IN THE EVENT OF A CONFLICT BETWEEN THE PRECEDING DOCUMENTS, THE CONTRACTOR SHALL INFORM THE RESIDENT ENGINEER IMMEDIATELY. THE MONO COUNTY ENGINEERING DEPARTMENT WILL DECIDE WHICH DOCUMENT APPLIES TO THE CONFLICT.
2. CONTRACTOR SHALL CONDUCT ALL GRADING OPERATIONS IN CONFORMANCE WITH THE CONSTRUCTION SAFETY ORDERS OF THE STATE OF CALIFORNIA, DEPARTMENT OF INDUSTRIAL RELATIONS, DIVISION OF INDUSTRIAL SAFETY. CONTRACTOR SHALL COMPLY WITH ALL REQUIREMENTS OF GENERAL OSHA STANDARDS FOR THE PROTECTION OF WORKMEN AND THE GENERAL PUBLIC.
3. CONTRACTOR SHALL CALL USA ALERT AT (800) 642-2444 AT LEAST 48 HOURS PRIOR TO STARTING WORK. UTILITIES SHOWN ON THESE PLANS ARE LOCATED BASED ON AVAILABLE RECORDS AND FIELD MEASUREMENTS. IT IS THE CONTRACTOR'S RESPONSIBILITY TO VERIFY THE EXACT LOCATION AND DEPTH OF ALL UTILITIES PRIOR TO CONSTRUCTION.
4. ANY EVIDENCE OF THE HISTORICAL PRESENCE OF MAN FOUND DURING CONSTRUCTION SHALL BE BROUGHT TO THE ATTENTION OF THE MONO COUNTY PUBLIC WORKS DEPARTMENT AND ALL CONSTRUCTION ACTIVITIES SHALL CEASE UNTIL AUTHORIZED BY THAT DEPARTMENT.
5. A PRE-CONSTRUCTION MEETING AT THE PROJECT SITE IS REQUIRED PRIOR TO COMMENCING ANY SITE ACTIVITIES. MONO COUNTY PUBLIC WORKS DEPARTMENT WILL COORDINATE THIS MEETING WITH THE CONTRACTOR AND OTHER RELEVANT AGENCIES. NO ON-SITE WORK SHALL COMMENCE PRIOR TO THE MEETING.
6. CONSTRUCTION ACTIVITIES SHALL BE LIMITED TO THE HOURS OF 7:00 AM TO 7:00 PM MONDAY THROUGH SATURDAY (NO OPERATIONS ALLOWED ON SUNDAY). CONTRACTOR SHALL KEEP NOISE LEVELS OF CONSTRUCTION EQUIPMENT TO A MINIMUM, USING SOUND MUFFLING DEVICES IN ACCORDANCE WITH PREVAILING REQUIREMENTS. SITE PREPARATION AND CONSTRUCTION SHALL BE CONDUCTED SO AS TO MINIMIZE EXCESSIVE NOISE, DUST, DEBRIS AND DISTURBANCE TO NEIGHBORS WITHIN 500 FEET.
7. THE LIMITS OF CONSTRUCTION SPECIFIED ON THESE PLANS SHALL BE CAREFULLY AND FULLY FLAGGED PRIOR TO START OF CONSTRUCTION IN A MANNER TO PREVENT DAMAGE TO VEGETATION AND DISTURBANCE TO SOILS OUTSIDE THE CONSTRUCTION AREA. SITE-DISTURBING ACTIVITIES SHALL BE RESTRICTED TO THE IDENTIFIED BOUNDARIES OF THE PROJECT.
8. RESTRICTIONS ON THE MOVEMENTS OF HEAVY EQUIPMENT SHALL BE ACCOMPLISHED THROUGH THE ESTABLISHMENT OF DESIGNATED TRAVEL ROUTES AND BARRIERS WHICH PREVENT CUTTING, SCARRING AND ROOT DAMAGE TO TREES AND SHRUBS NOT BEING REMOVED.
9. CONTRACTOR SHALL BE RESPONSIBLE FOR, AND WILL BEAR THE COST OF, RESETTING ANY SURVEY STAKES OR MONUMENTS DESTROYED BY HIS OPERATIONS.
10. CONTRACTOR IS RESPONSIBLE FOR ALL TRAFFIC CONTROL. TRAFFIC CONTROL PLANS SHALL BE SUBMITTED TO ENGINEER FOR APPROVAL. WORK SHALL NOT BEGIN UNTIL WRITTEN APPROVAL OF TRAFFIC CONTROL PLAN IS PROVIDED TO CONTRACTOR. TEMPORARY ROAD CLOSURES MAY BE AUTHORIZED FOR THIS PROJECT OF NO MORE THAN 2 HOURS.

GRADING:

11. AREAS TO BE GRADED SHALL BE CLEARED OF BRUSH, VEGETATION, LARGE BOULDERS, AND OTHER DELETERIOUS MATERIALS. WASTE MATERIALS SHALL BE DISPOSED OF BY THE CONTRACTOR TO A LOCATION APPROVED AND PERMITTED TO RECEIVE SUCH MATERIAL.
12. TOPSOIL REMOVED DURING CLEARING ACTIVITIES SHALL BE STOCKPILED WITHIN THE APPROVED LIMITS OF CONSTRUCTION FOR RE-APPLICATION TO SLOPES AND DISTURBED AREAS UPON PROJECT COMPLETION. STOCKPILE LOCATION SHALL BE IN ACCORDANCE WITH THE APPROVED STORM WATER POLLUTION PREVENTION PLAN (SWPPP).
13. SURPLUS OR WASTE MATERIAL SHALL NOT BE PLACED IN DRAINAGEWAYS.
14. CONTRACTOR SHALL TAKE ALL NECESSARY MEASURES TO CONTROL DUST IN CONSTRUCTION AREAS AND ON SITE ACCESS ROADS. SUFFICIENT WATER SHALL BE MADE AVAILABLE FOR DUST CONTROL PURPOSES. ALL EXPOSED SOIL SURFACES WILL BE MOISTENED AS REQUIRED TO AVOID NUISANCE CONDITIONS AND INCONVENIENCES FOR LOCAL RESIDENTS, BUSINESSES, AND TRAVELERS OF NEARBY ROADWAYS.
15. FINAL CUT AND FILL SLOPES SHALL NOT EXCEED A STEEPNESS OF 2:1 UNLESS OTHERWISE NOTED ON THESE PLANS.
16. FINISHED GRADES IN ALL AREAS SHALL BE CONSTRUCTED IN ACCORDANCE WITH THESE PLANS. NO AREAS SHALL BE LEFT SUCH THAT A PONDING CONDITION OCCURS, EXCEPT WHERE NOTED.

EROSION CONTROL:

17. CONSTRUCTION ACTIVITIES SHALL BE PERFORMED IN ACCORDANCE WITH THE WATER POLLUTION CONTROL PLAN (WPCP) OR THE APPROVED STORM WATER POLLUTION PREVENTION PLAN (SWPPP), AS APPLICABLE. STOCKPILED MATERIALS AND EQUIPMENT STORAGE AREAS SHALL BE LOCATED AS SPECIFIED IN THE APPROVED REPORT. TEMPORARY EROSION CONTROL FACILITIES SHALL BE IN PLACE PRIOR TO COMMENCING ANY GRADING OPERATIONS. UPON COMPLETION OF CONSTRUCTION, PERMANENT EROSION CONTROL FACILITIES SHALL BE PLACED AS DESIGNATED IN THE APPROVED REPORT. IT IS THE RESPONSIBILITY OF THE CONTRACTOR TO MAINTAIN A COPY OF THE WPCP OR SWPPP ON-SITE AT ALL TIMES DURING CONSTRUCTION.
18. DURING CONSTRUCTION, TEMPORARY EROSION CONTROL MEASURES SUCH AS BERMS, SILT FENCES, FIBER ROLLS, EROSION CONTROL BLANKETS, OR OTHER METHODS SHALL BE INSTALLED AS NECESSARY TO PREVENT DISCHARGE OF EARTHEN MATERIALS FROM THE SITE DURING PERIODS OF PRECIPITATION OR RUNOFF. SIMILAR MEASURES SHALL BE INSTALLED ON OR AROUND ANY SOIL STOCKPILE LOCATED ADJACENT TO PUBLIC ROADWAYS, RESIDENCES, OR BUSINESSES, IN THE VICINITY OF BODIES OF WATER, OR WHEN REMAINING ON-SITE FOR AN EXTENDED PERIOD.
19. CONTRACTOR SHALL TAKE ALL SUCH MEASURES NECESSARY TO RETAIN SOIL AND SEDIMENT ON-SITE AND TO PREVENT TRACKING OF MUD AND DIRT ONTO PUBLIC ROADWAYS.
20. ALL EXPOSED SOIL SURFACES TO REMAIN SHALL BE STABILIZED AND RE-SEEDING IN ACCORDANCE WITH THE WATER POLLUTION CONTROL PLAN (WPCP) OR APPROVED STORM WATER POLLUTION PREVENTION PLAN (SWPPP), AS APPLICABLE. SEEDING SLOPES SHALL BE PROTECTED BY INSTALLATION OF AN EROSION CONTROL BLANKET, SECURED IN ACCORDANCE WITH MANUFACTURER'S RECOMMENDATIONS.
21. AT NO TIME SHALL THE CONTRACTOR DEWATER THE PROJECT SITE BY PUMPING INTO BODIES OF WATER, STORM DRAINS, OR A SUBDRAIN SYSTEM.

MATERIALS:

22. COMPACTION TESTING SHALL BE PERFORMED BY THE GEOTECHNICAL ENGINEER AS REQUIRED IN THE PROJECT SPECIFICATIONS. SHOULD ANY COMPACTION TEST FAIL TO MEET THE SPECIFIED MINIMUM DENSITY, THE DEFICIENCY SHALL BE CORRECTED AT THE EXPENSE OF THE CONTRACTOR PRIOR TO ANY ADDITIONAL WORK.
23. BOTTOM GRADE OR SUBGRADE IN AREAS TO RECEIVE FILL SHALL BE SCARIFIED, MOISTURE-CONDITIONED, AND COMPACTED TO A MINIMUM OF 90% OF THE MATERIAL'S MAXIMUM DRY DENSITY FOR THE UPPER 12 INCHES.
24. SUBGRADE IN AREAS TO BE PAVED SHALL BE SCARIFIED, MOISTURE-CONDITIONED, AND COMPACTED TO A MINIMUM OF 95% OF THE MATERIAL'S MAXIMUM DRY DENSITY FOR THE UPPER 12 INCHES.
25. STRUCTURAL FILL MATERIAL SHALL BE PLACED IN MAXIMUM 8-INCH LIFTS AND COMPACTED TO A MINIMUM OF 95% OF THE MATERIAL'S MAXIMUM DRY DENSITY. SUBGRADE SHALL BE COMPACTED TO 95% OF THE MAXIMUM DRY DENSITY FOR THE UPPER 12 INCHES. EXISTING SLOPES OF 5:1 OR STEEPER TO RECEIVE FILL SHALL BE KEYED WITH EQUIPMENT-WIDTH BENCHES PRIOR TO COMPACTION AND FILL PLACEMENT.
26. EARTHEN MATERIAL IMPORTED OR EXCAVATED ON THE PROPERTY MAY BE UTILIZED IN THE FILL, PROVIDED THAT EACH MATERIAL HAS BEEN DETERMINED TO BE SUITABLE BY THE GEOTECHNICAL AND RESIDENT ENGINEER. ALL FILL MATERIAL SHALL BE FREE OF ROCKS GREATER THAN 3-INCHES IN DIAMETER AND ORGANIC DELETERIOUS MATERIAL. SOILS OF POOR GRADATION, EXPANSION POTENTIAL, OR STRENGTH CHARACTERISTICS SHALL BE PLACED IN AREAS DESIGNATED BY THE ENGINEER OR SHALL BE MIXED WITH OTHER SOILS TO SERVE AS SATISFACTORY FILL MATERIAL AS DETERMINED BY THE GEOTECHNICAL ENGINEER.
27. AGGREGATE BASE SHALL BE CLASS 2, 3/4" MAXIMUM GRADING, AND CONFORM TO THE PROVISIONS OF SECTION 26 "AGGREGATE BASES" OF THE CALTRANS STANDARD SPECIFICATIONS (2015). AGGREGATE BASE SHALL BE MOISTURE CONDITIONED AND COMPACTED TO A MINIMUM OF 95% OF THE MATERIAL'S MAXIMUM DRY DENSITY.
28. ASPHALT CONCRETE PAVING SHALL BE GRADE PG 64-28 WITH 3/4" MAXIMUM MEDIUM GRADING, CONFORMING TO THE PROVISIONS OF SECTION 39, "ASPHALT CONCRETE," OF THE CALTRANS STANDARD SPECIFICATIONS (2015). ASPHALT MAY CONTAIN UP TO 15% RAP. AN ASPHALT CONCRETE MIX DESIGN SHALL BE SUBMITTED BY THE CONTRACTOR AND APPROVED BY MONO COUNTY PRIOR TO THE START OF PAVING. PAVEMENT LIFTS SHALL BE COMPACTED AS SPECIFIED IN SECTION 39 OF THE PROJECT SPECIFICATIONS.
29. A FOG SEAL COAT OF SS-1 OR CSS-1 ASPHALT SHALL BE APPLIED AT A RATE OF 0.05 TO 0.15 GALLONS PER SQUARE YARD TO THE FINAL SURFACE OF ALL ASPHALT CONCRETE PAVING. A TACK COAT OF SS-1 OR CSS-1 ASPHALT SHALL BE APPLIED BETWEEN PAVEMENT LIFTS AT A RATE OF 0.10 GALLONS PER SQUARE YARD. SEAL COAT AND TACK COAT MATERIALS AND APPLICATION SHALL CONFORM TO THE PROVISIONS OF SECTION 94, "ASPHALTIC EMULSIONS", OF THE 2015 CALTRANS STANDARD SPECIFICATIONS.
30. CONCRETE SHALL BE CLASS A CONFORMING TO THE PROVISIONS OF SECTION 90, "PORTLAND CEMENT CONCRETE", OF THE 2015 CALTRANS STANDARD SPECIFICATIONS. CONCRETE SHALL CONTAIN 5% ±1.0% ENTRAINED AIR AND SHALL HAVE A MINIMUM 28-DAY COMPRESSIVE STRENGTH OF 5,000 PSI, UNLESS OTHERWISE NOTED. REINFORCING STEEL SHALL BE DEFORMED BILLET-STEEL BARS CONFORMING TO SPECIFICATIONS OF ASTM A615 GRADE 60.
31. CORRUGATED METAL PIPE SHALL BE 14 GAUGE AND THE FABRICATION AND INSTALLATION SHALL CONFORM TO THE PROVISIONS OF SECTION 66, "CORRUGATED METAL PIPE", OF THE 2015 CALTRANS STANDARD SPECIFICATIONS.
32. FABRICATION AND INSTALLATION OF CORRUGATED PLASTIC PIPE SHALL CONFORM TO THE PROVISIONS SECTION 64, "PLASTIC PIPE", OF THE 2015 CALTRANS STANDARD SPECIFICATIONS.
33. FLARED END SECTIONS, DROP INLETS, AND GRATES SHALL CONFORM TO THE PROVISIONS OF SECTION 75 "MISCELLANEOUS METAL" AND SECTION 70 "MISCELLANEOUS FACILITIES" OF THE 2015 CALTRANS STANDARD SPECIFICATIONS.
34. BACKFILL AND BEDDING MATERIAL FOR CULVERTS AND UTILITY TRENCHES SHALL COMPLY WITH PROJECT PLANS AND APPLICABLE PROVISIONS OF THE 2015 CALTRANS STANDARD SPECIFICATIONS. SLURRY CEMENT BACKFILL SHALL CONFORM TO THE PROVISIONS OF SECTION 19-3.062, "SLURRY CEMENT BACKFILL", OF THE 2015 CALTRANS STANDARD SPECIFICATIONS.

REFERENCED CALTRANS STANDARD PLANS (2015):

1. A20A: PAVEMENT MARKERS AND TRAFFIC LINES TYPICAL DETAILS
2. A20B: PAVEMENT MARKERS AND TRAFFIC LINES TYPICAL DETAILS
3. A20D: PAVEMENT MARKINGS WORDS
4. A24E: PAVEMENT MARKINGS, WORDS, LIMIT, AND YIELD LINES

ABBREVIATIONS

AB	AGGREGATE BASE	INV	INVERT
AC	ASPHALT CONCRETE	LF	LINEAR FEET
CMP	CORRUGATED METAL PIPE	LP	LOW POINT
CY	CUBIC YARDS	MAX	MAXIMUM
CT	CALTRANS	MIN	MINIMUM
EBL	EAST BOUND LANE	NBL	NORTHBOUND LANE
EG	EXISTING GRADE	R/W	RIGHT-OF-WAY
ELEV	ELEVATION	SBL	SOUTHBOUND LANE
EPS	EDGE OF PAVEMENT SURFACE	SY	SQUARE YARDS
ETW	EDGE OF TRAVELED WAY	STA	STATION
EX	EXISTING	STD	STANDARD
HMA	HOT MIX ASPHALT	TYP	TYPICAL
		WBL	WEST BOUND LANE

MONO CITY ASPHALT CONCRETE CORING DATA		
LOCATION	LANE	THICKNESS (IN)
EAST MONO LAKE DRIVE	WBL	6.16

BENTON CROSSING ASPHALT CONCRETE CORING DATA		
LOCATION	LANE	THICKNESS (IN)
1,764 FT NORTHEAST OF HWY 395	EBL	3.82
7,122 FT NORTHEAST OF HWY 395	WBL	3.54

LEGEND

- ROAD RIGHT-OF-WAY
- ROAD CENTERLINE
- ~ 6500 ~ EXISTING GROUND CONTOUR & ELEV.
- PROPOSED ASPHALT-RUBBER CHIP SEAL AREA

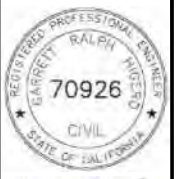

EXP. 6/30/2021

SIGNED:

06/24/2019

MONO COUNTY PUBLIC WORKS DEPARTMENT

Revision	Date	Rev.#
Drawing Date: 06/24/2019	Prepared By: CAS	Checked By: GRH

MONO CITY ROADS & BENTON CROSSING ROAD

ROAD MAINTENANCE PROJECT (NO. 9304-9305)
GENERAL CONSTRUCTION NOTES
AND SITEWORK SPECIFICATIONS

SHEET
T2

MONO CITY ROADS MAINTENANCE PROJECT

PROJECT NO. 9304-9305

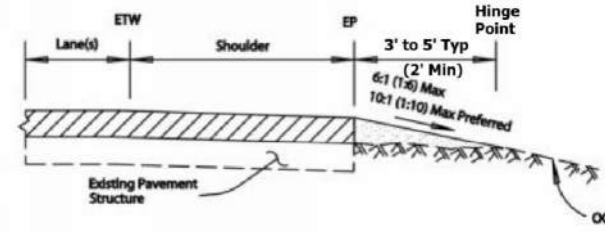

SHOULDER BACKING DETAIL
NOT TO SCALE

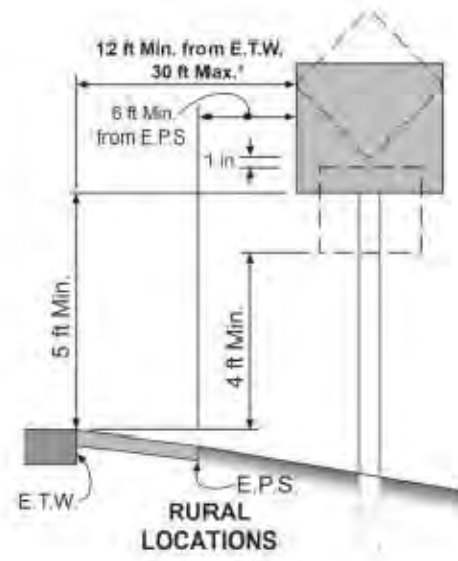

ROADWAY SIGN PLACEMENT DETAIL
CA MUTCD

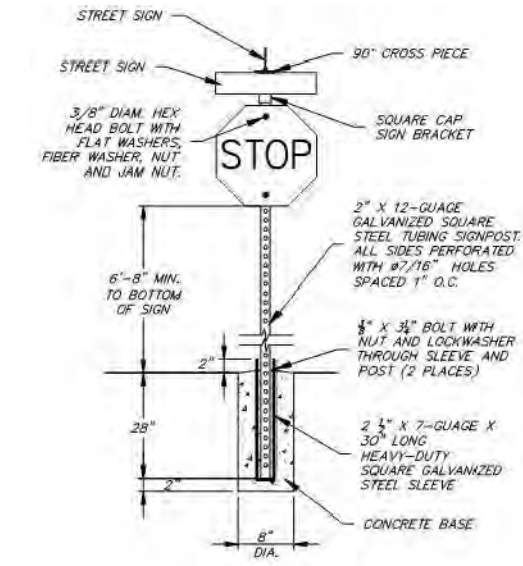

- NOTES:**
- SIGN MATERIALS, CONSTRUCTION AND PLACEMENT SHALL BE IN CONFORMANCE WITH THE LATEST EDITION OF THE CALIFORNIA MANUAL OF UNIFORM TRAFFIC CONTROL DEVICES.
 - SIGNS SHALL BE MOUNTED WITH TAMPER PROOF HARDWARE.

STEEL-POST ROAD SIGN DETAIL
NOT TO SCALE

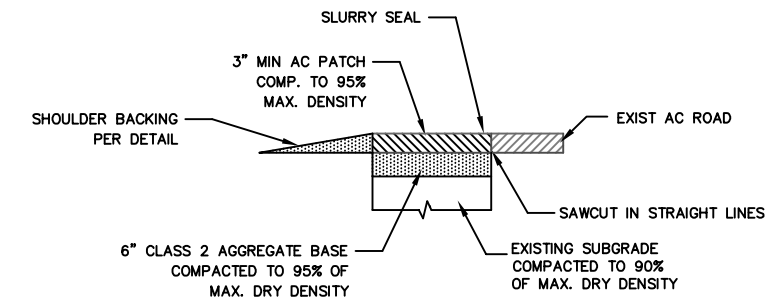

ROAD AC REPAIR DETAIL
NOT TO SCALE

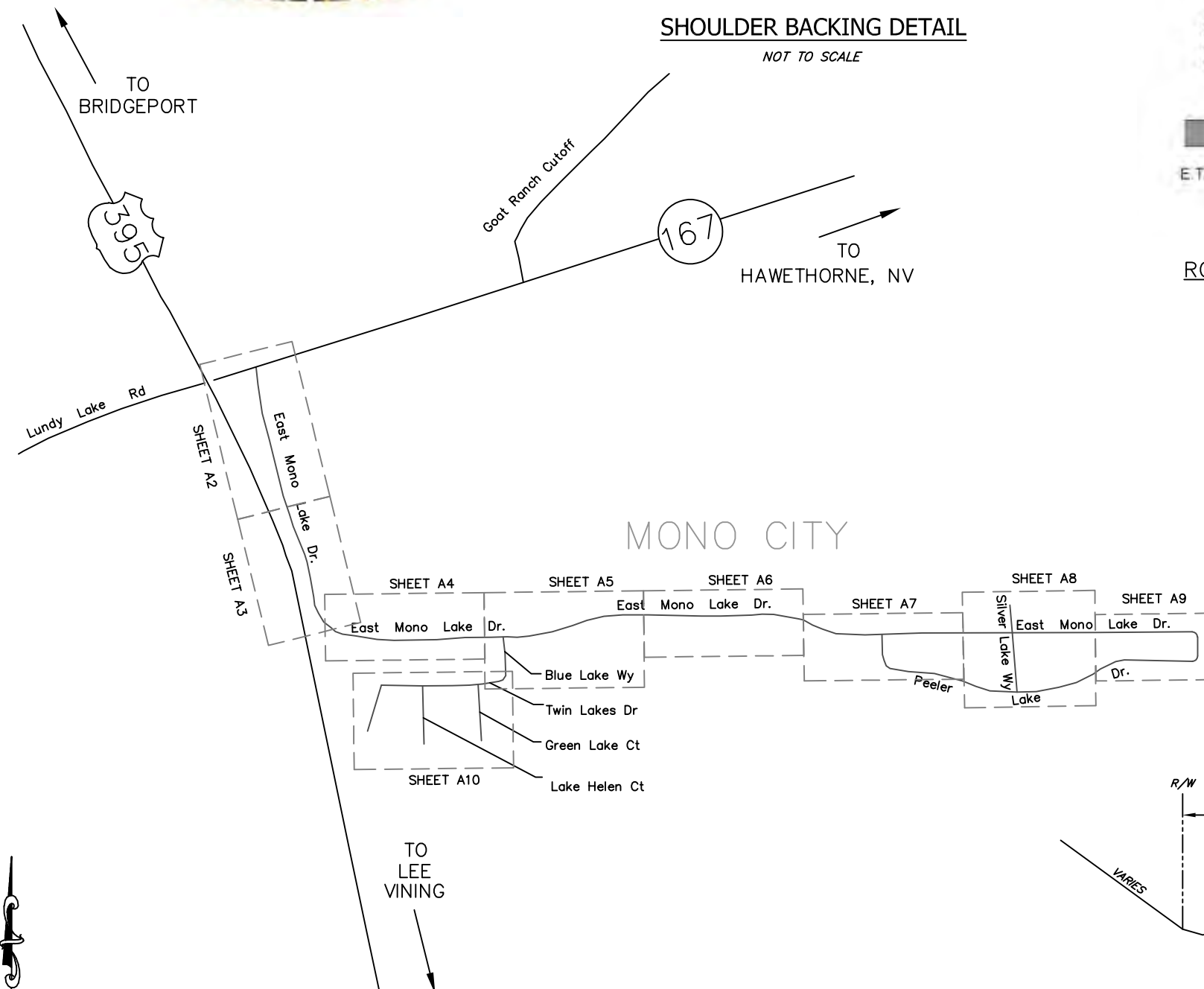

MONO CITY ROADS SHEET INDEX
NOT TO SCALE

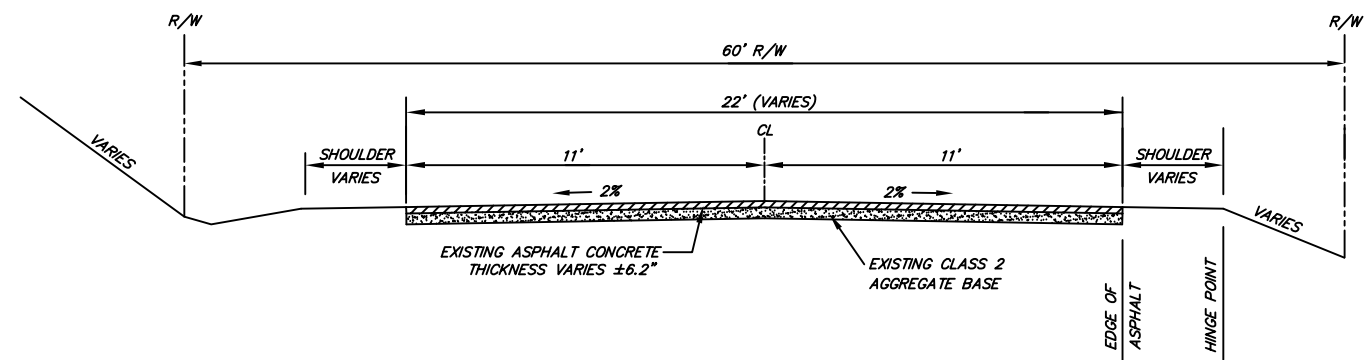

MONO CITY - TYPICAL ROAD CROSS SECTION
NOT TO SCALE



EXP. 6/30/2021
SIGNED: 06/24/2019

MONO COUNTY PUBLIC WORKS DEPARTMENT	Revision	
	Date	
	Rev.#	
	Drawing Date: 06/24/2019	
MONO CITY	Prepared By: CAS	
	Checked By: GRH	

ROAD MAINTENANCE PROJECT (NO. 9304-9305)

SHEET INDEX, TYPICAL ROAD SECTION, & DETAILS

SHEET
A1



① EAST MONO LAKE DRIVE STA 1+03.49 TO 8+50
 SLURRY SEAL AREA = 1,825 sq yds

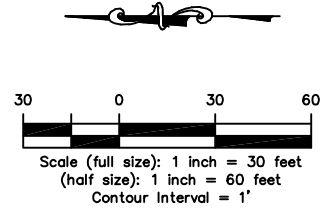

① CONSTRUCTION LEGEND

1. SLURRY SEAL EXISTING ROADWAY PER SECTION 37 OF THE PROJECT SPECIFICATIONS.
2. REMOVE EXISTING STOP SIGN AND STREET SIGN, AND SALVAGE FOR FUTURE USE. INSTALL NEW STOP SIGN (R1-1, 30"X30") WITH SALVAGED "E MONO LAKE DR" STREET SIGN PER STEEL POST ROAD SIGN DETAIL ON SHEET A1 AND PROJECT SPECIFICATIONS, SECTION 82.
3. REPLACE EXISTING WOOD SIGN POST AND WITH STEEL SIGN POST PER STEEL POST ROAD SIGN DETAIL ON SHEET A1 AND PROJECT SPECIFICATIONS, SECTION 82. SALVAGE EXISTING WOOD POST FOR FUTURE USE.
4. PLACE AND COMPACT SHOULDER BACKING ALONG EDGE OF EXISTING ASPHALT CONCRETE PER SECTION 19 OF PROJECT SPECIFICATIONS AND DETAIL ON SHEET A1; STA 1+03 TO STA 8+50.



EXP. 6/30/2021
 SIGNED: 06/24/2019

MONO COUNTY PUBLIC WORKS DEPARTMENT			
Drawing Date:	06/24/2019	Rev.#	
Prepared By:	CAS	Date	
Checked By:	GRH	Revision	

MONO CITY
 ROAD MAINTENANCE PROJECT (NO. 9304-9305)
 EAST MONO LAKE DR. STA 1+03.49 TO STA 8+50

SHEET
A2

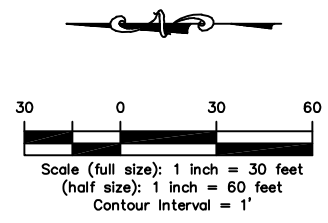

② EAST MONO LAKE DRIVE STA 8+50 TO 16+50
 SLURRY SEAL AREA = 1,956 sq yds

① CONSTRUCTION LEGEND

1. SLURRY SEAL EXISTING ROADWAY PER SECTION 37 OF THE PROJECT SPECIFICATIONS.
2. PLACE AND COMPACT SHOULDER BACKING ALONG EDGE OF EXISTING ASPHALT CONCRETE PER SECTION 19 OF PROJECT SPECIFICATIONS AND DETAIL ON SHEET A1; NBL STA 8+50 TO STA 16+50, SBL STA 8+50 TO STA 16+50.



EXP. 6/30/2021
 SIGNED: 06/24/2019

MONO COUNTY PUBLIC WORKS DEPARTMENT			
Rev.#	Date	Revision	
06/24/2019			
Drawing Date: 06/24/2019		CAS	GRH
Prepared By: CAS		Checked By: GRH	

MONO CITY
 ROAD MAINTENANCE PROJECT (NO. 9304-9305)
 EAST MONO LAKE DR. STA 8+50 TO STA 16+50

SHEET
A3



③ EAST MONO LAKE DRIVE STA 16+50 TO 25+00
 SLURRY SEAL AREA = 2,078 sq yds

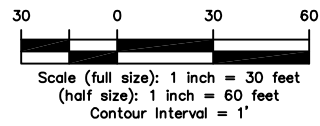

③ CONSTRUCTION LEGEND

1. SLURRY SEAL EXISTING ROADWAY PER SECTION 37 OF THE PROJECT SPECIFICATIONS.
2. REMOVE EXISTING SIGN AND SALVAGE FOR FUTURE USE. INSTALL NEW PEDESTRIAN WARNING SIGN (W11-2, 30"X30") PER STEEL POST ROAD SIGN DETAIL ON SHEET A1 AND PROJECT SPECIFICATIONS, SECTION 82.
3. REPLACE EXISTING WOOD SIGN POST AND WITH STEEL SIGN POST PER STEEL POST ROAD SIGN DETAIL ON SHEET A1 AND PROJECT SPECIFICATIONS, SECTION 82. SALVAGE EXISTING WOOD POST FOR FUTURE USE.
4. PLACE AND COMPACT SHOULDER BACKING ALONG EDGE OF EXISTING ASPHALT CONCRETE PER SECTION 19 OF PROJECT SPECIFICATIONS AND DETAIL ON SHEET A1; STA 16+50 TO STA 25+00.



Janet Rigney
 EXP. 6/30/2021
 SIGNED:
 06/24/2019

MONO COUNTY PUBLIC WORKS DEPARTMENT			
Drawing Date: 06/24/2019	Rev.#	Date	Revision
Prepared By: CAS			
Checked By: GRH			

MONO CITY
 ROAD MAINTENANCE PROJECT (NO. 9304-9305)
 EAST MONO LAKE DR. STA 16+50 TO STA 25+00

SHEET
A4

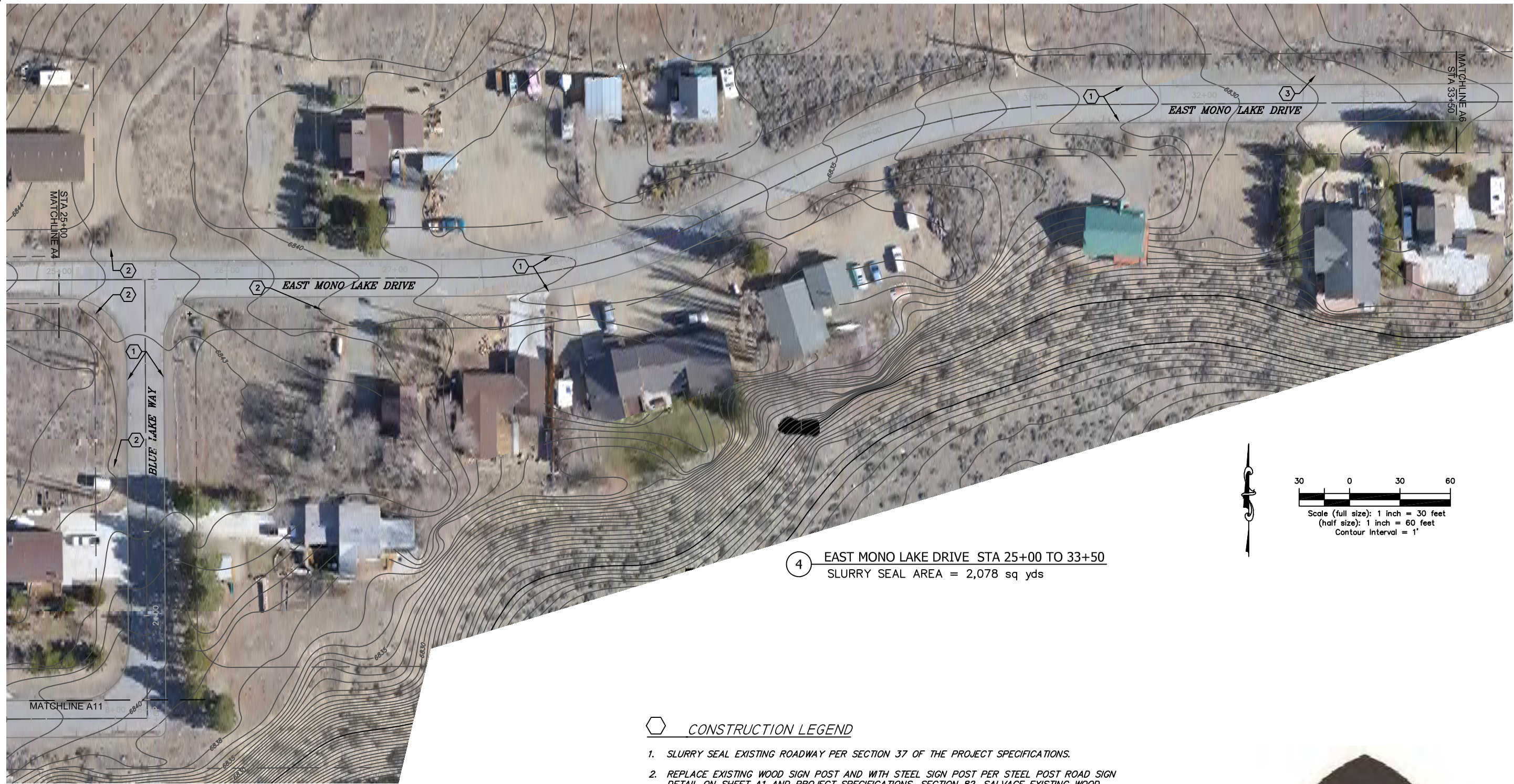

1 BLUE LAKE WAY STA 0+00 TO 2+61.12
 SLURRY SEAL AREA = 650 sq yds

4 EAST MONO LAKE DRIVE STA 25+00 TO 33+50
 SLURRY SEAL AREA = 2,078 sq yds

CONSTRUCTION LEGEND

1. SLURRY SEAL EXISTING ROADWAY PER SECTION 37 OF THE PROJECT SPECIFICATIONS.
2. REPLACE EXISTING WOOD SIGN POST AND WITH STEEL SIGN POST PER STEEL POST ROAD SIGN DETAIL ON SHEET A1 AND PROJECT SPECIFICATIONS, SECTION 82. SALVAGE EXISTING WOOD POST FOR FUTURE USE.
3. REMOVE EXISTING SIGN AND SALVAGE FOR FUTURE USE. INSTALL NEW PEDESTRIAN WARNING SIGN (W11-2, 30"X30") PER STEEL POST ROAD SIGN DETAIL ON SHEET A1 AND PROJECT SPECIFICATIONS, SECTION 82.



EXP. 6/30/2021
 SIGNED:
 06/24/2019

MONO COUNTY PUBLIC WORKS DEPARTMENT

Rev.#	Date	Revision
06/24/2019		
CAS		
GRH		

Drawing Date: 06/24/2019
 Prepared By: CAS
 Checked By: GRH

MONO CITY

ROAD MAINTENANCE PROJECT (NO. 9304-9305)
 EAST MONO LAKE DR. STA 25+00 TO STA 33+50
 BLUE LAKE WAY STA 0+00 TO STA 2+61.12

SHEET
A5

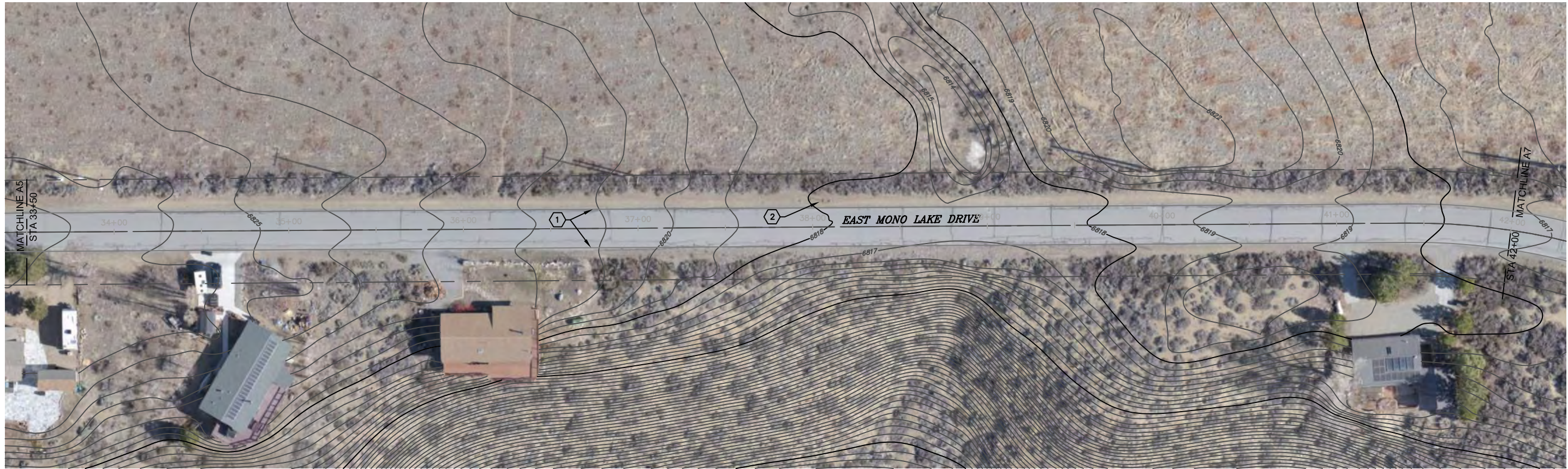

5 EAST MONO LAKE DRIVE STA 33+50 TO 42+00
 SLURRY SEAL AREA = 2,078 sq yds

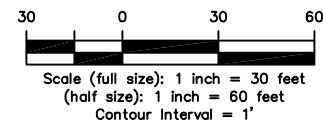

CONSTRUCTION LEGEND

1. SLURRY SEAL EXISTING ROADWAY PER SECTION 37 OF THE PROJECT SPECIFICATIONS.
2. REPLACE EXISTING WOOD SIGN POST AND WITH STEEL SIGN POST PER STEEL POST ROAD SIGN DETAIL ON SHEET A1 AND PROJECT SPECIFICATIONS, SECTION 82. SALVAGE EXISTING WOOD POST FOR FUTURE USE.



EXP. 6/30/2021
 SIGNED: 06/24/2019

MONO COUNTY PUBLIC WORKS DEPARTMENT

Rev.#	Date	Revision

Drawing Date: 06/24/2019
 Prepared By: CAS
 Checked By: GRH

MONO CITY
 ROAD MAINTENANCE PROJECT (NO. 9304-9305)
 EAST MONO LAKE DR. STA 33+50 TO STA 42+00

SHEET
A6

6 EAST MONO LAKE DRIVE STA 42+00 TO 50+50
 SLURRY SEAL AREA = 2,078 sq yds

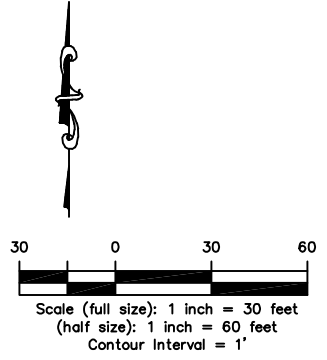

CONSTRUCTION LEGEND

1. SLURRY SEAL EXISTING ROADWAY PER SECTION 37 OF THE PROJECT SPECIFICATIONS.
2. REPLACE EXISTING WOOD SIGN POST AND WITH STEEL SIGN POST PER STEEL POST ROAD SIGN DETAIL ON SHEET A1 AND PROJECT SPECIFICATIONS, SECTION 82. SALVAGE EXISTING WOOD POST FOR FUTURE USE.
3. REMOVE EXISTING SIGN AND SALVAGE FOR FUTURE USE. INSTALL NEW PEDESTRIAN WARNING SIGN (W11-2, 30"X30") PER STEEL POST ROAD SIGN DETAIL ON SHEET A1 AND PROJECT SPECIFICATIONS, SECTION 82.
4. EXCAVATE AND REPLACE EXISTING ASPHALT CONCRETE PER ROAD AC REPAIR DETAIL ON SHEET A1. PLACE MINIMUM OF 3" HMA ON 6" CLASS 2 AGGREGATE BASE PER PROJECT SPECIFICATIONS, SECTION 26 AND 39.

1 PEELER LAKE DRIVE STA 0+00 TO 5+50
 SLURRY SEAL AREA = 1,374 sq yds



James Rigdon
 EXP. 6/30/2021
 SIGNED:
 06/24/2019

MONO COUNTY PUBLIC WORKS DEPARTMENT	
Drawing Date: 06/24/2019	Rev. #
Prepared By: CAS	Date
Checked By: GRH	Revision

MONO CITY
 ROAD MAINTENANCE PROJECT (NO. 9304-9305)
 EAST MONO LAKE DRIVE STA 42+00 TO STA 50+50
 PEELER LAKE DRIVE STA 0+00 TO STA 5+50

SHEET
A7

1 SILVER LAKE WAY STA 0+00 TO 4+68
SLURRY SEAL AREA = 1,134 sq yds

7 EAST MONO LAKE DRIVE STA 50+50 TO 59+00
SLURRY SEAL AREA = 2,078 sq yds



2 PEELER LAKE DRIVE STA 5+50 TO 14+00
SLURRY SEAL AREA = 2,078 sq yds

CONSTRUCTION LEGEND

1. SLURRY SEAL EXISTING ROADWAY PER SECTION 37 OF THE PROJECT SPECIFICATIONS.
2. REPLACE EXISTING WOOD SIGN POST AND WITH STEEL SIGN POST PER STEEL POST ROAD SIGN DETAIL ON SHEET A1 AND PROJECT SPECIFICATIONS, SECTION 82. SALVAGE EXISTING WOOD POST FOR FUTURE USE.
3. EXCAVATE AND REPLACE EXISTING ASPHALT CONCRETE PER ROAD AC REPAIR DETAIL ON SHEET A1. PLACE MINIMUM OF 3" HMA ON 6" CLASS 2 AGGREGATE BASE PER PROJECT SPECIFICATIONS, SECTION 26 AND 39.

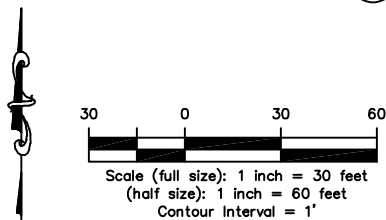

Garrett Ralph Hedges
EXP. 6/30/2021
SIGNED:
06/24/2019

MONO COUNTY PUBLIC WORKS DEPARTMENT	
Rev.#	Date
06/24/2019	
Prepared By: CAS	Checked By: GRH

MONO CITY
ROAD MAINTENANCE PROJECT (NO. 9304-9305)
EAST MONO LAKE DR. STA 50+50 TO STA 59+00,
PEELER LAKE DR. STA 5+50 TO STA 14+00, & SILVER LAKE WAY

SHEET
A8

8 EAST MONO LAKE DRIVE STA 59+00 TO 65+07
 SLURRY SEAL AREA = 1,485 sq yds



3 PEELER LAKE DRIVE STA 14+00 TO 22+40
 SLURRY SEAL AREA = 2,055 sq yds

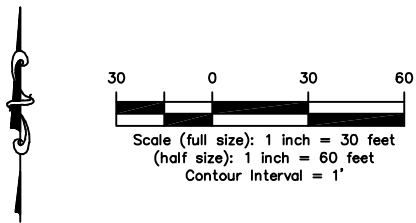

CONSTRUCTION LEGEND

1. SLURRY SEAL EXISTING ROADWAY PER SECTION 37 OF THE PROJECT SPECIFICATIONS.
2. REPLACE EXISTING WOOD SIGN POST AND WITH STEEL SIGN POST PER STEEL POST ROAD SIGN DETAIL ON SHEET A1 AND PROJECT SPECIFICATIONS, SECTION 82. SALVAGE EXISTING WOOD POST FOR FUTURE USE.
3. REMOVE EXISTING SIGN AND SALVAGE FOR FUTURE USE. INSTALL NEW PEDESTRIAN WARNING SIGN (W11-2, 30"X30") PER STEEL POST ROAD SIGN DETAIL ON SHEET A1 AND PROJECT SPECIFICATIONS, SECTION 82.
4. EXCAVATE AND REPLACE EXISTING ASPHALT CONCRETE PER ROAD AC REPAIR DETAIL ON SHEET A1. PLACE MINIMUM OF 3" HMA ON 6" CLASS 2 AGGREGATE BASE PER PROJECT SPECIFICATIONS, SECTION 26 AND 39.



Jamot Ridgway
 EXP. 6/30/2021
 SIGNED:
 06/24/2019

MONO COUNTY PUBLIC WORKS DEPARTMENT			
Rev.#	Date	Revision	
06/24/2019			
Drawing Date: 06/24/2019		Prepared By: CAS	Checked By: GRH

MONO CITY
 ROAD MAINTENANCE PROJECT (NO. 9304-9305)
 EAST MONO LAKE DRIVE STA 59+00 TO STA 65+07
 PEELER LAKE DRIVE STA 14+00 TO STA 22+40

SHEET
A9

30 0 30 60
 Scale (full size): 1 inch = 30 feet
 (half size): 1 inch = 60 feet
 Contour Interval = 1'

1 TWIN LAKES DRIVE STA 0+00 TO 8+19
 SLURRY SEAL AREA = 2,020 sq yds



1 LAKE HELEN DRIVE STA 0+00 TO 2+27
 SLURRY SEAL AREA = 725 sq yds

1 GREEN LAKE CT STA 0+00 TO 1+69
 SLURRY SEAL AREA = 538 sq yds

CONSTRUCTION LEGEND

1. SLURRY SEAL EXISTING ROADWAY PER SECTION 37 OF THE PROJECT SPECIFICATIONS.
2. REPLACE EXISTING WOOD SIGN POST AND WITH STEEL SIGN POST PER STEEL POST ROAD SIGN DETAIL ON SHEET A1 AND PROJECT SPECIFICATIONS, SECTION 82. SALVAGE EXISTING WOOD POST FOR FUTURE USE.
3. EXCAVATE AND REPLACE EXISTING ASPHALT CONCRETE PER ROAD AC REPAIR DETAIL ON SHEET A1. PLACE MINIMUM OF 3" HMA ON 6" CLASS 2 AGGREGATE BASE PER PROJECT SPECIFICATIONS, SECTION 26 AND 39.
4. INSTALL NEW STREET SIGN (GREEN LAKE CT.) PER STEEL POST ROAD SIGN DETAIL ON SHEET A1 AND PROJECT SPECIFICATIONS, SECTION 82.



EXP. 6/30/2021
 SIGNED:
 06/24/2019

MONO COUNTY PUBLIC WORKS DEPARTMENT

Rev.#	Date	Revision
06/24/2019		

Drawing Date: 06/24/2019
 Prepared By: CAS
 Checked By: GRH

MONO CITY

ROAD MAINTENANCE PROJECT (NO. 9304-9305)
 BLUE LAKE WAY, TWIN LAKES DRIVE,
 GREEN LAKE CT., & LAKE HELEN CT.

SHEET
 A10



BENTON CROSSING ROAD (PHASE 1) ROAD MAINTENANCE PROJECT PROJECT NO. 9304-9305



EXP. 6/30/2021
SIGNED: 06/24/2019

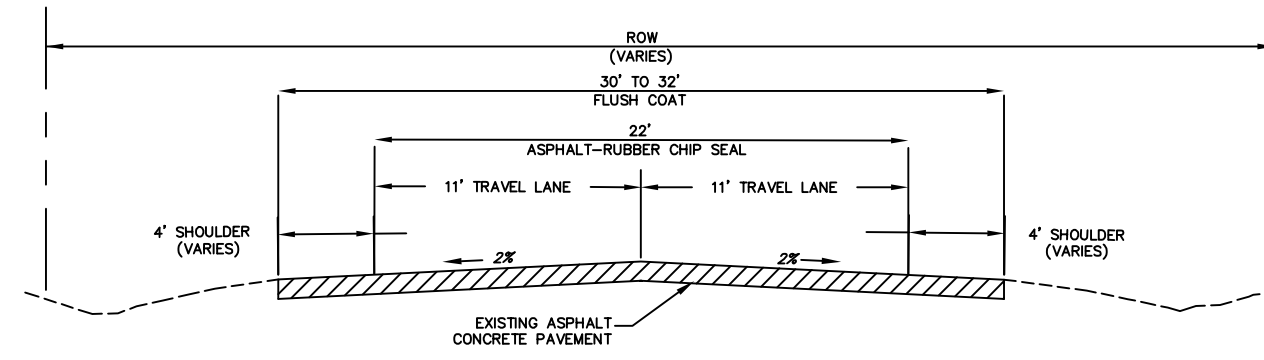
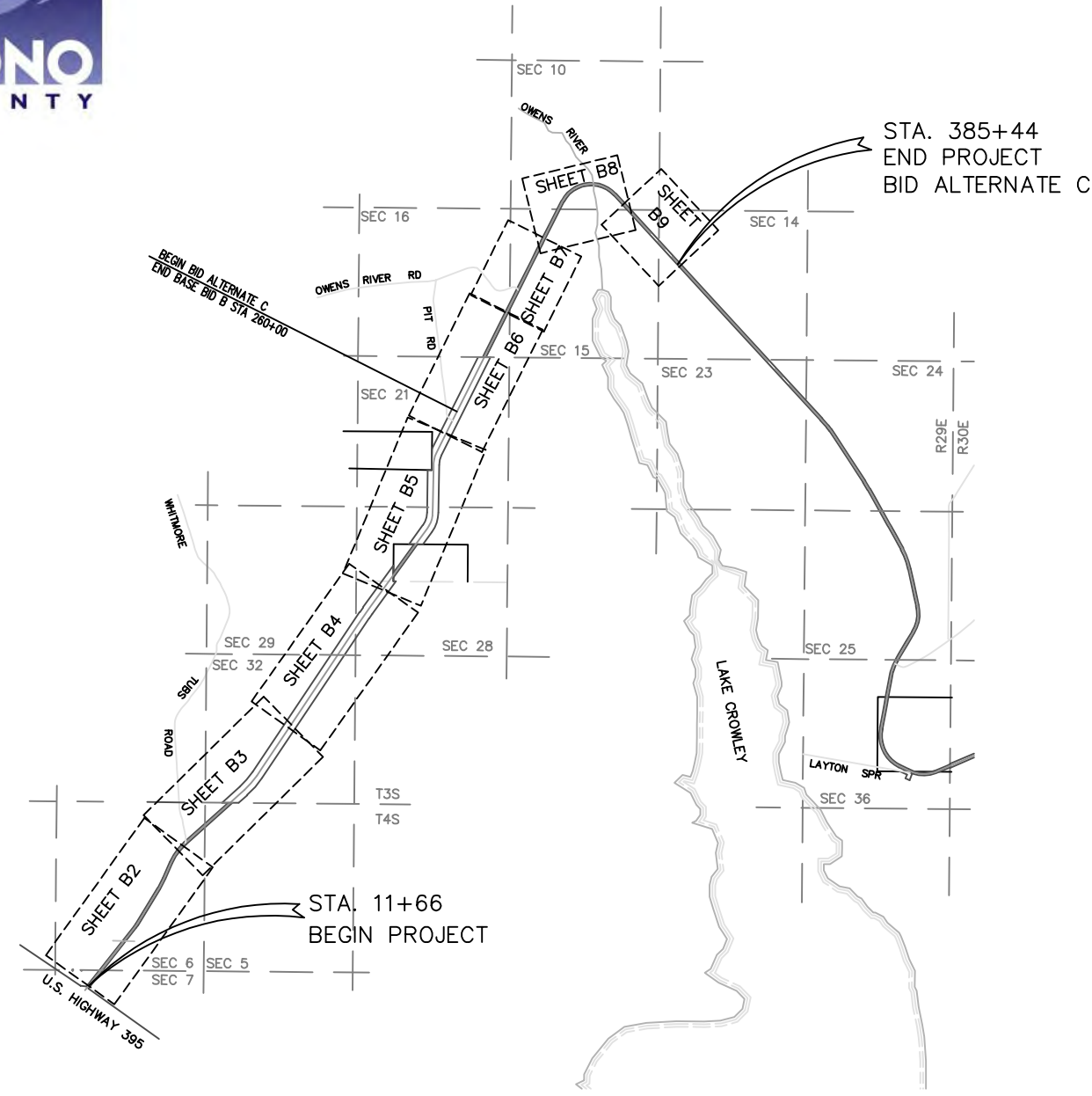

BENTON CROSSING ROAD TYPICAL ROAD SECTION
NOT TO SCALE

BENTON CROSSING ROAD - SHEET INDEX
NOT TO SCALE

MONO COUNTY PUBLIC WORKS DEPARTMENT			
Rev.#	Date	Revision	
06/24/2019			
Prepared By:	CAS	Checked By:	GRH
Drawing Date:	06/24/2019		

BENTON CROSSING ROAD (PHASE 1)
ROAD MAINTENANCE PROJECT (NO. 9304-9305)
BENTON CROSSING ROAD
SHEET INDEX AND EXISTING ROAD SECTIONS

SHEET
B1

SECTION 7
T4S,R29E,MDB&M

SECTION 6
T4S,R29E,MDB&M

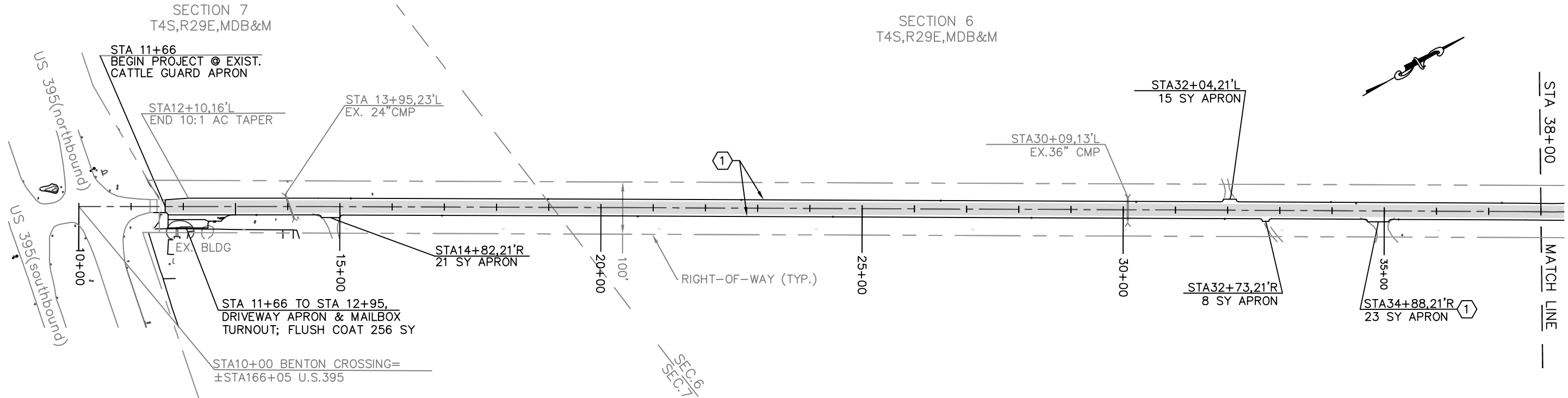

LEGEND

- ROAD RIGHT-OF-WAY
- - - ROAD CENTERLINE
- ▭ PROPOSED ASPHALT-RUBBER CHIP SEAL AREA

① BENTON CROSSING RD STA 11+66 TO 38+00
CHIP SEAL AREA = 6,440 sq yds
FLUSH COAT AREA = 9,412 sq yds

① CONSTRUCTION LEGEND

1. ASPHALT-RUBBER CHIP SEAL 22' WIDE TRAVEL LANES PER SECTION 37 OF THE PROJECT SPECIFICATIONS. AFTER CHIP SEALING, FLUSH COAT ENTIRE ROAD WIDTH INCLUDING SHOULDERS AND ROAD APRONS.
2. RESTORE EXISTING PAINT STRIPING AND PAINT MARKINGS PER ROAD STRIPING PLAN ON SHEET B10.
3. REPLACE EXISTING ROAD SIGNS PER ROAD SIGN PLAN SHEET B11.

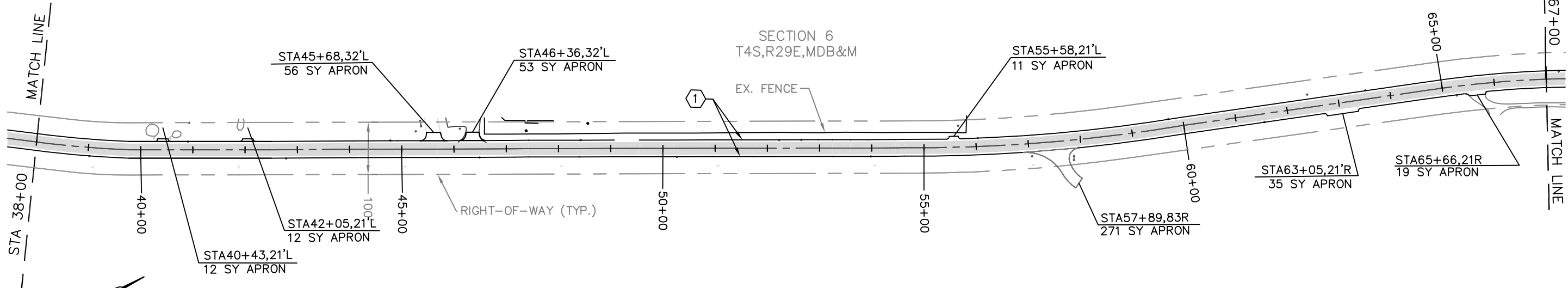
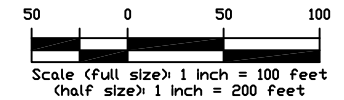

② BENTON CROSSING RD STA 38+00 TO 67+00
CHIP SEAL AREA = 7,089 sq yds
FLUSH COAT AREA = 10,787 sq yds



EXP. 6/30/2021
SIGNED: 06/24/2019

MONO COUNTY PUBLIC WORKS DEPARTMENT	
Rev.#	Date
06/24/2019	CAS
	GRH
Drawing Date:	Prepared By:
06/24/2019	CAS
	GRH
	Checked By:

BENTON CROSSING ROAD (PHASE 1)
ROAD MAINTENANCE PROJECT (NO. 9304-9305)
BENTON CROSSING ROAD
STA 11+66 TO STA 67+00

SHEET
B2

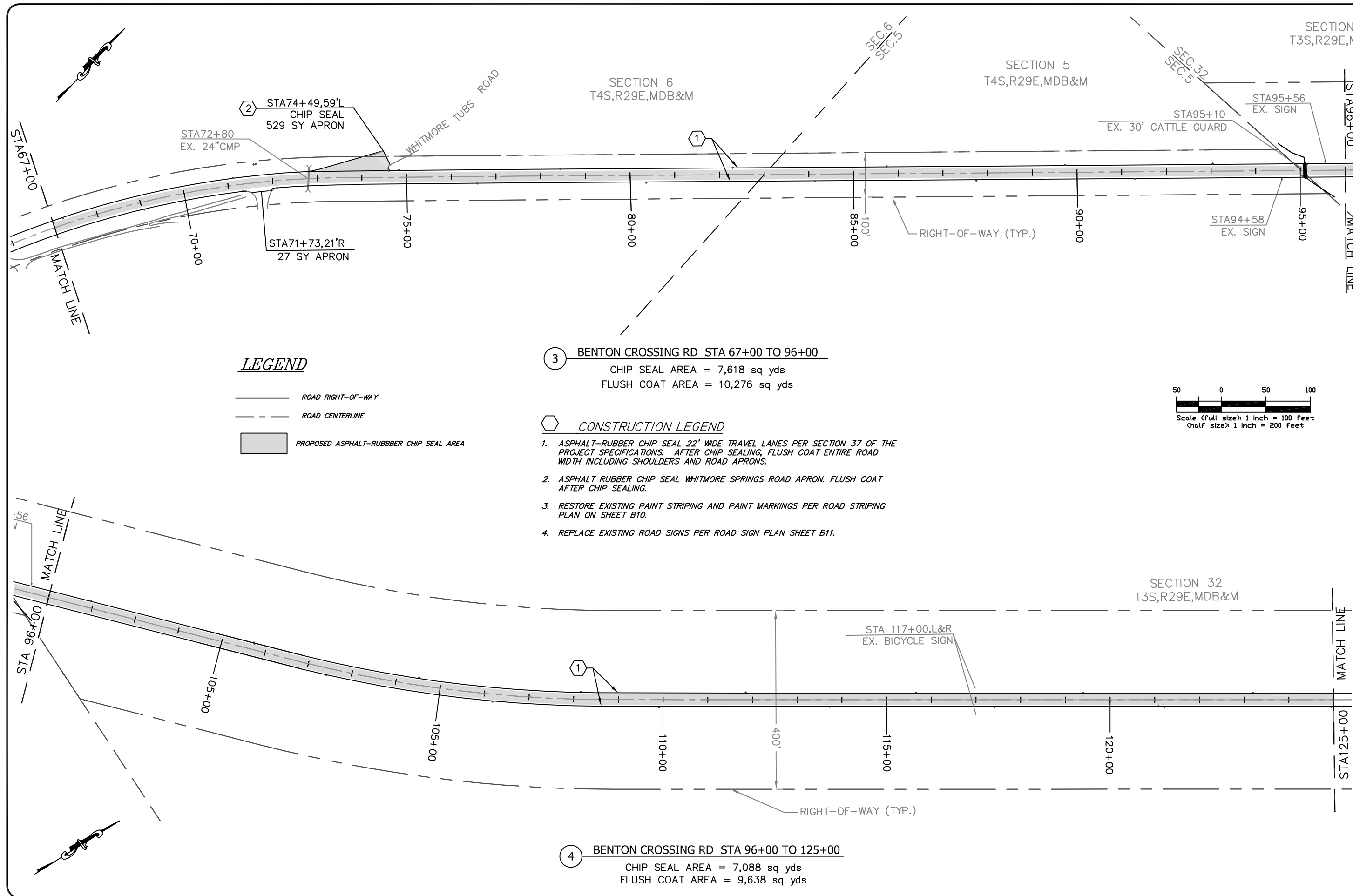

LEGEND

- ROAD RIGHT-OF-WAY
- - - ROAD CENTERLINE
- PROPOSED ASPHALT-RUBBER CHIP SEAL AREA

3 BENTON CROSSING RD STA 67+00 TO 96+00
 CHIP SEAL AREA = 7,618 sq yds
 FLUSH COAT AREA = 10,276 sq yds

CONSTRUCTION LEGEND

1. ASPHALT-RUBBER CHIP SEAL 22' WIDE TRAVEL LANES PER SECTION 37 OF THE PROJECT SPECIFICATIONS. AFTER CHIP SEALING, FLUSH COAT ENTIRE ROAD WIDTH INCLUDING SHOULDERS AND ROAD APRONS.
2. ASPHALT RUBBER CHIP SEAL WHITMORE SPRINGS ROAD APRON. FLUSH COAT AFTER CHIP SEALING.
3. RESTORE EXISTING PAINT STRIPING AND PAINT MARKINGS PER ROAD STRIPING PLAN ON SHEET B10.
4. REPLACE EXISTING ROAD SIGNS PER ROAD SIGN PLAN SHEET B11.

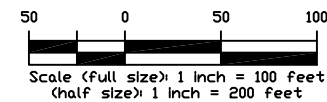

EXP. 6/30/2021
 SIGNED: 06/24/2019

Revision	Date	Rev.#

Drawing Date: 06/24/2019
 Prepared By: CAS
 Checked By: GRH

BENTON CROSSING ROAD (PHASE 1)
 ROAD MAINTENANCE PROJECT (NO. 9304-9305)
 BENTON CROSSING ROAD
 STA 67+00 TO STA 125+00

SHEET
B3



Garrett Ralph
 EXP. 6/30/2021
 SIGNED:
 06/24/2019

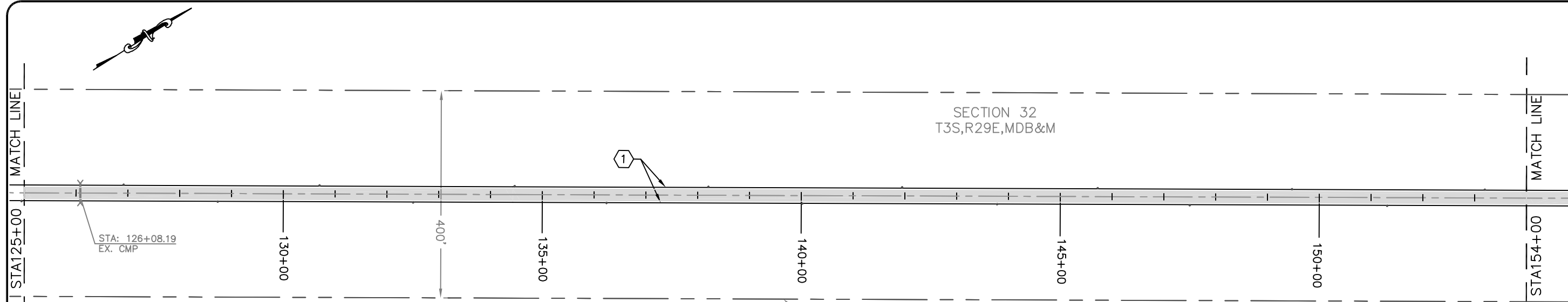

LEGEND

- ROAD RIGHT-OF-WAY
- ROAD CENTERLINE
- PROPOSED ASPHALT-RUBBER CHIP SEAL AREA

5 BENTON CROSSING RD STA 125+00 TO 154+00
 CHIP SEAL AREA = 7,089 sq yds
 FLUSH COAT AREA = 9,667 sq yds

CONSTRUCTION LEGEND

1. ASPHALT-RUBBER CHIP SEAL 22' WIDE TRAVEL LANES PER SECTION 37 OF THE PROJECT SPECIFICATIONS. AFTER CHIP SEALING, FLUSH COAT ENTIRE ROAD WIDTH INCLUDING SHOULDERS AND ROAD APRONS.
2. RESTORE EXISTING PAINT STRIPING AND PAINT MARKINGS PER ROAD STRIPING PLAN ON SHEET B10.
3. REPLACE EXISTING ROAD SIGNS PER ROAD SIGN PLAN SHEET B11.

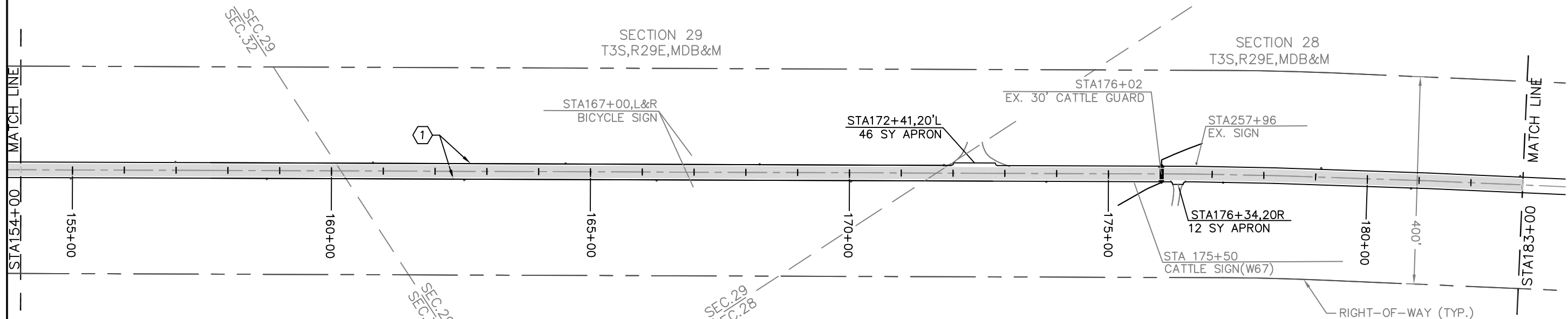
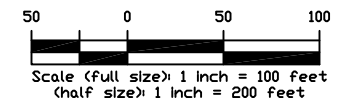

6 BENTON CROSSING RD STA 154+00 TO 183+00
 CHIP SEAL AREA = 7,089 sq yds
 FLUSH COAT AREA = 9,724 sq yds

MONO COUNTY PUBLIC WORKS DEPARTMENT

Rev.#	Date	Revision
06/24/2019		

Drawing Date: 06/24/2019
 Prepared By: CAS
 Checked By: GRH

BENTON CROSSING ROAD (PHASE 1)
 ROAD MAINTENANCE PROJECT (NO. 9304-9305)
 BENTON CROSSING ROAD
 STA 125+00 TO STA 183+00

SHEET
B4

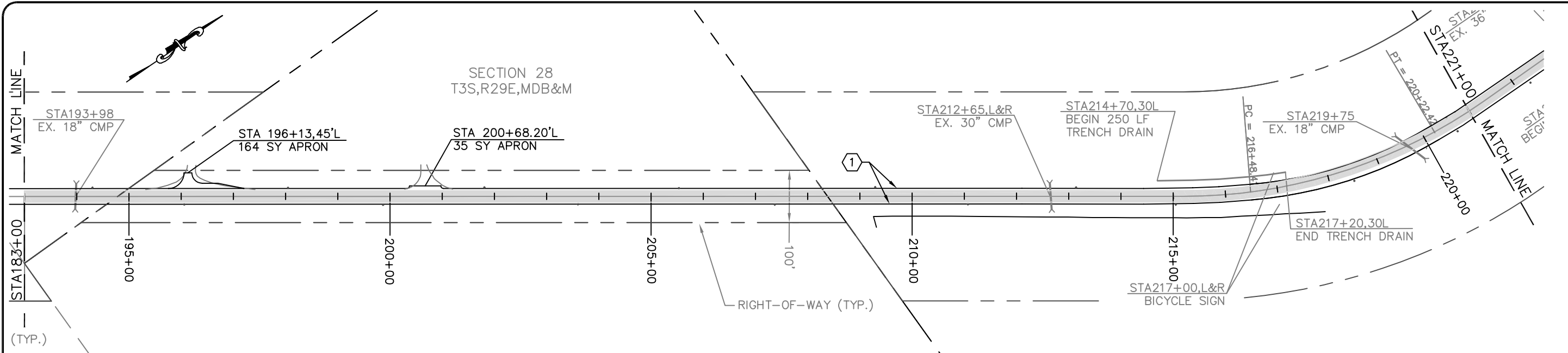

LEGEND

- ROAD RIGHT-OF-WAY
- - - ROAD CENTERLINE
- ▭ PROPOSED ASPHALT-RUBBER CHIP SEAL AREA

7 BENTON CROSSING RD STA 183+00 TO 221+00

CHIP SEAL AREA = 6,841 sq yds
 FLUSH COAT AREA = 9,533 sq yds

CONSTRUCTION LEGEND

1. ASPHALT-RUBBER CHIP SEAL 22' WIDE TRAVEL LANES PER SECTION 37 OF THE PROJECT SPECIFICATIONS. AFTER CHIP SEALING, FLUSH COAT ENTIRE ROAD WIDTH INCLUDING SHOULDERS AND ROAD APRONS.
2. RESTORE EXISTING PAINT STRIPING AND PAINT MARKINGS PER ROAD STRIPING PLAN ON SHEET B10.
3. REPLACE EXISTING ROAD SIGNS PER ROAD SIGN PLAN SHEET B11.

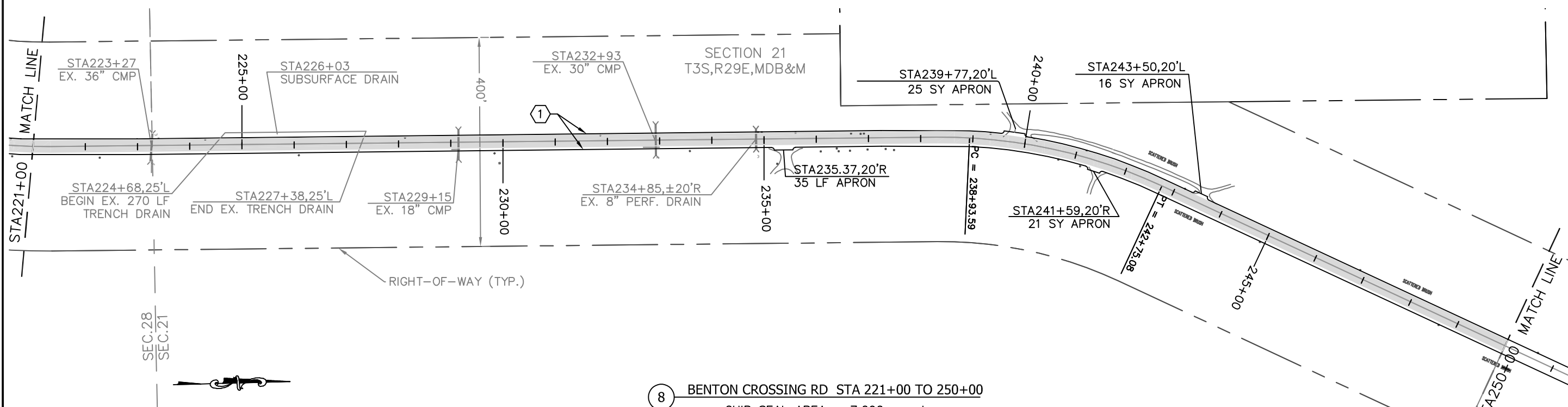
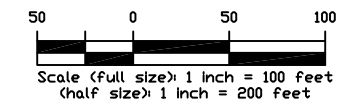

8 BENTON CROSSING RD STA 221+00 TO 250+00

CHIP SEAL AREA = 7,090 sq yds
 FLUSH COAT AREA = 9,740 sq yds

EXP. 6/30/2021
 SIGNED: 06/24/2019

MONO COUNTY PUBLIC WORKS DEPARTMENT	
Rev.#	Date

Drawing Date: 06/24/2019
 Prepared By: CAS
 Checked By: GRH

BENTON CROSSING ROAD (PHASE 1)
 ROAD MAINTENANCE PROJECT (NO. 9304-9305)
 BENTON CROSSING ROAD
 STA 183+00 TO STA 250+00

SHEET
B5

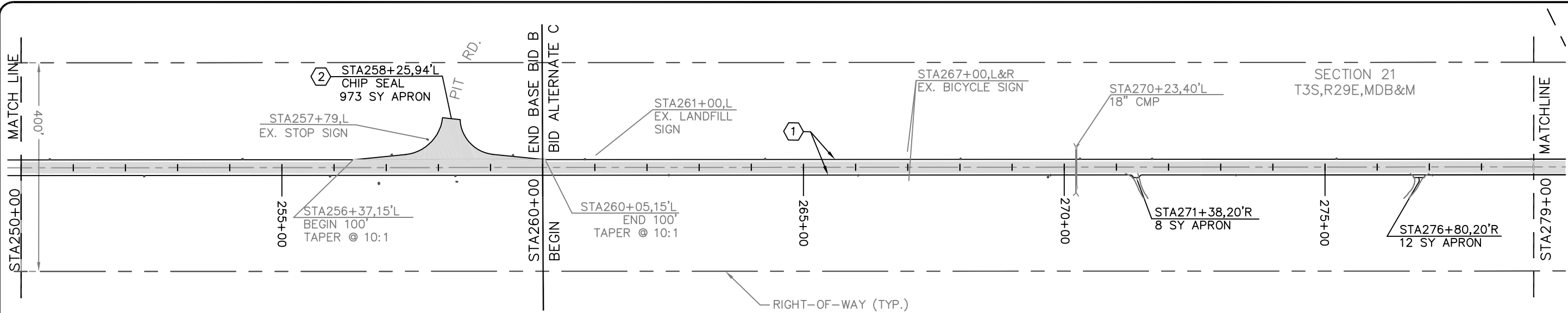

9 BENTON CROSSING RD STA 250+00 TO 279+00
 CHIP SEAL AREA = 8,062 sq yds
 FLUSH COAT AREA = 10,499 sq yds

LEGEND

- ROAD RIGHT-OF-WAY
- - - ROAD CENTERLINE
- PROPOSED ASPHALT-RUBBER CHIP SEAL AREA

CONSTRUCTION LEGEND

1. ASPHALT-RUBBER CHIP SEAL 22' WIDE TRAVEL LANES PER SECTION 37 OF THE PROJECT SPECIFICATIONS. AFTER CHIP SEALING, FLUSH COAT ENTIRE ROAD WIDTH INCLUDING SHOULDERS AND ROAD APRONS.
2. ASPHALT-RUBBER CHIP SEAL PIT ROAD APRON. FLUSH COAT ROAD APRON AFTER CHIP SEALING.
3. RESTORE EXISTING PAINT STRIPING AND PAINT MARKINGS PER ROAD STRIPING PLAN ON SHEET B10.
4. REPLACE EXISTING ROAD SIGNS PER ROAD SIGN PLAN SHEET B11.

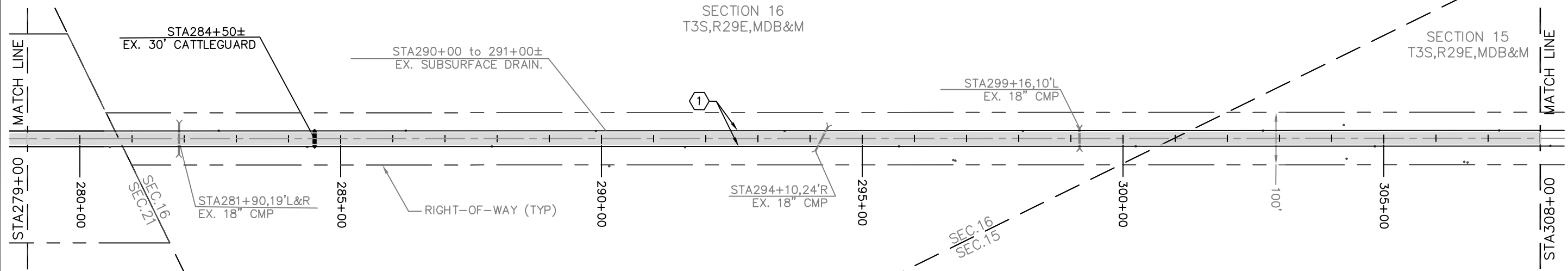
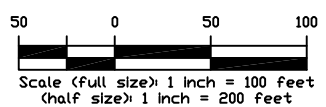

10 BENTON CROSSING RD STA 279+00 TO 308+00
 CHIP SEAL AREA = 9,667 sq yds
 FLUSH COAT AREA = 7,089 sq yds



EXP. 6/30/2021
 SIGNED: 06/24/2019

MONO COUNTY PUBLIC WORKS DEPARTMENT	
Rev.#	Date
06/24/2019	CAS
	GRH
Drawing Date:	Prepared By:
06/24/2019	CAS
	GRH
Checked By:	

BENTON CROSSING ROAD (PHASE 1)
 ROAD MAINTENANCE PROJECT (NO. 9304-9305)
 BENTON CROSSING ROAD
 STA 250+00 TO STA 308+00

SHEET
B6



EXP. 6/30/2021
 SIGNED:
 06/24/2019

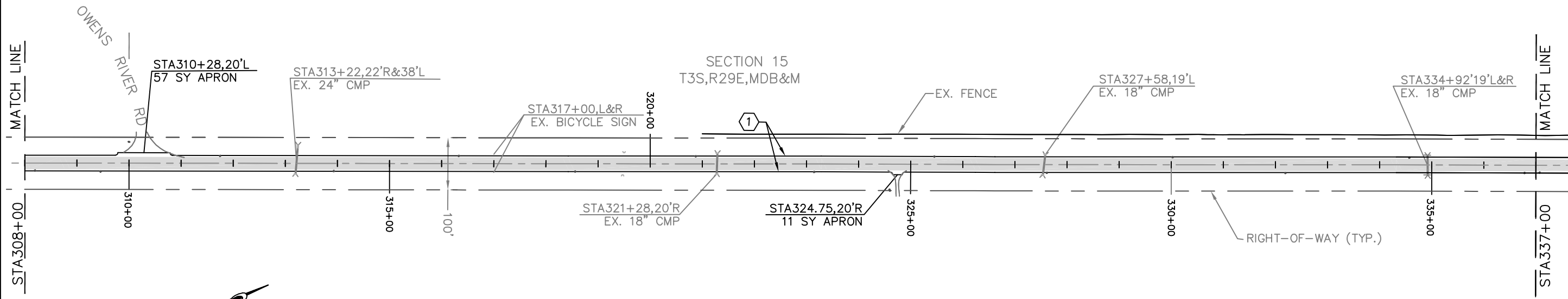

11 BENTON CROSSING RD STA 308+00 TO 337+00
 CHIP SEAL AREA = 7,089 sq yds
 FLUSH COAT AREA = 9,735 sq yds

LEGEND

- ROAD RIGHT-OF-WAY
- - - ROAD CENTERLINE
- PROPOSED ASPHALT-RUBBER CHIP SEAL AREA

CONSTRUCTION LEGEND

1. ASPHALT-RUBBER CHIP SEAL 22' WIDE TRAVEL LANES PER SECTION 37 OF THE PROJECT SPECIFICATIONS. AFTER CHIP SEALING, FLUSH COAT ENTIRE ROAD WIDTH INCLUDING SHOULDERS AND ROAD APRONS.
2. RESTORE EXISTING PAINT STRIPING AND PAINT MARKINGS PER ROAD STRIPING PLAN ON SHEET B10.
3. REPLACE EXISTING ROAD SIGNS PER ROAD SIGN PLAN SHEET B11.

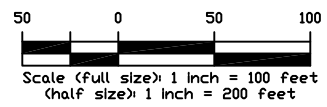

MONO COUNTY PUBLIC WORKS DEPARTMENT			
Rev.#	Date	Revision	
06/24/2019		CAS	
		GRH	

Drawing Date: 06/24/2019
 Prepared By: CAS
 Checked By: GRH

BENTON CROSSING ROAD (PHASE 1)
 ROAD MAINTENANCE PROJECT (NO. 9304-9305)
 BENTON CROSSING ROAD - BID ALTERNATE C
 STA 308+00 TO STA 337+00

SHEET
B7

SECTION 10
T3S,R29E,MDB&M

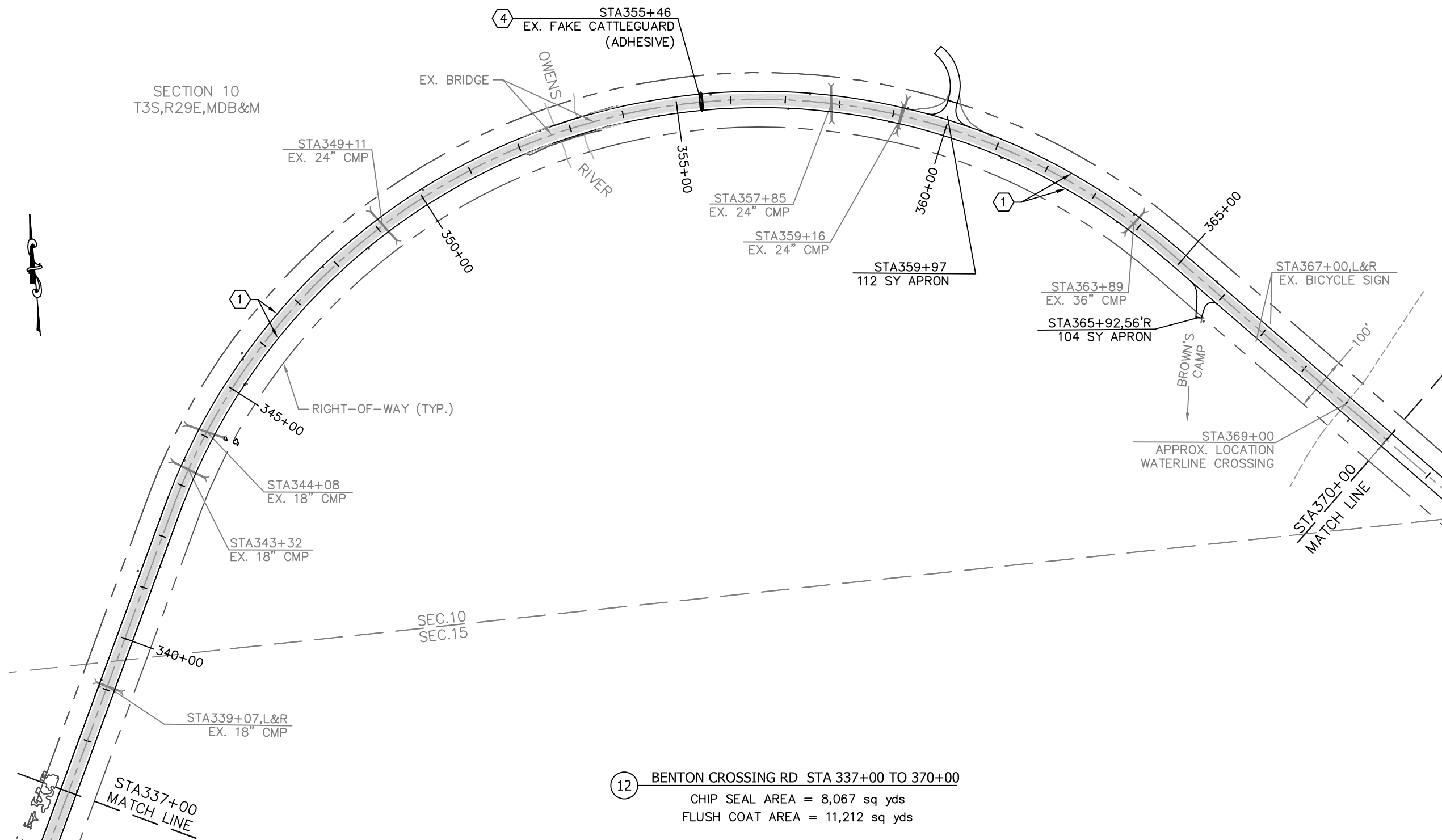

LEGEND

- ROAD RIGHT-OF-WAY
- - - ROAD CENTERLINE
- PROPOSED ASPHALT-RUBBER CHIP SEAL AREA

12 BENTON CROSSING RD STA 337+00 TO 370+00
 CHIP SEAL AREA = 8,067 sq yds
 FLUSH COAT AREA = 11,212 sq yds

CONSTRUCTION LEGEND

1. ASPHALT-RUBBER CHIP SEAL 22' WIDE TRAVEL LANES PER SECTION 37 OF THE PROJECT SPECIFICATIONS. AFTER CHIP SEALING, FLUSH COAT ENTIRE ROAD WIDTH INCLUDING SHOULDERS AND ROAD APRONS.
2. RESTORE EXISTING PAINT STRIPING AND PAINT MARKINGS PER ROAD STRIPING PLAN ON SHEET B10.
3. REPLACE EXISTING ROAD SIGNS PER ROAD SIGN PLAN SHEET B11.
4. REMOVE EXISTING FAKE-ADHESIVE CATTLEGUARD PRIOR TO CHIP SEALING. PAINT NEW FAKE CATTLEGUARD AFTER CHIP SEALING PROCESS.

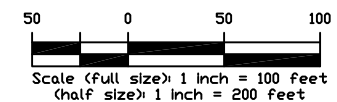

EXP. 6/30/2021
 SIGNED: 06/24/2019

MONO COUNTY PUBLIC WORKS DEPARTMENT	
Rev. #	Revision
Date	Date
06/24/2019	CAS
	GRH
Drawing Date:	Prepared By:
06/24/2019	CAS
	GRH
	Checked By:

BENTON CROSSING ROAD (PHASE 1)
 ROAD MAINTENANCE PROJECT (NO. 9304-9305)
 BENTON CROSSING ROAD - BID ALTERNATE C
 STA 337+00 TO STA 370+00

SHEET
B8



EXP. 6/30/2021

SIGNED:
06/24/2019

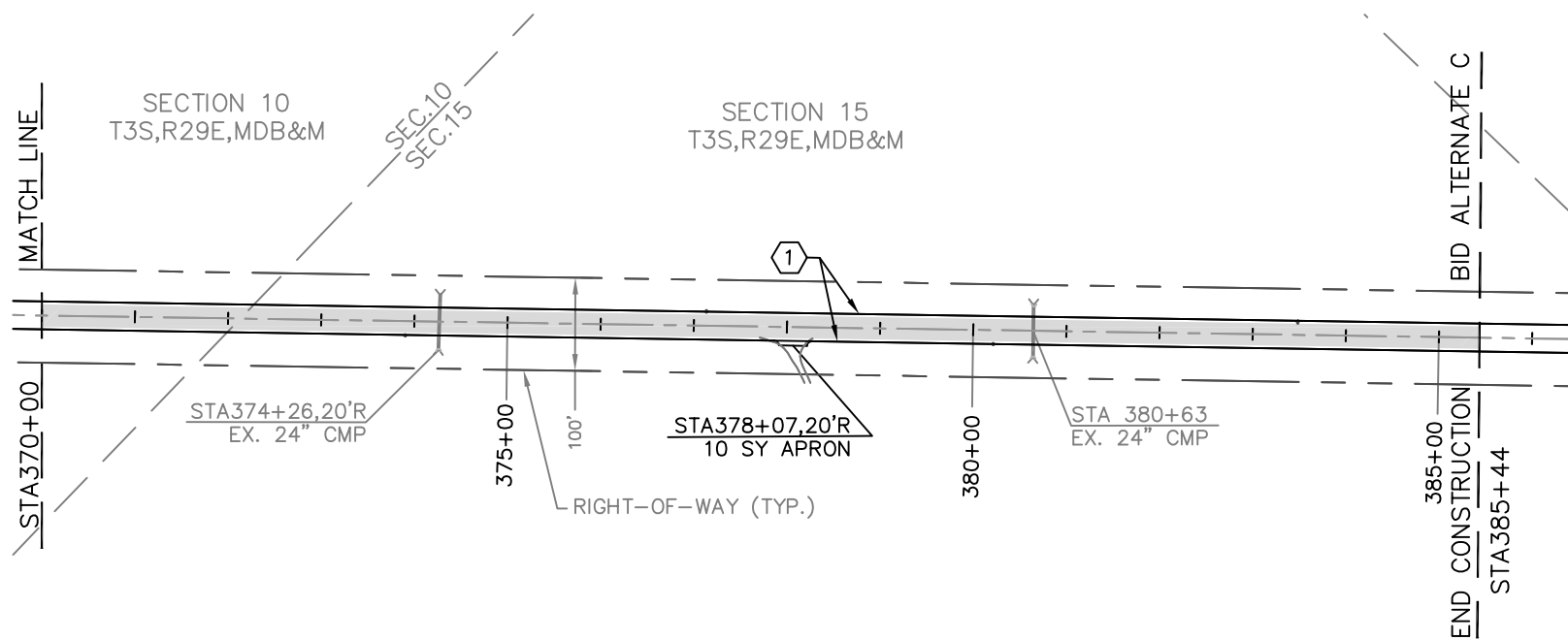

13 BENTON CROSSING RD STA 370+00 TO 398+00
 CHIP SEAL AREA = 3,773 sq yds
 FLUSH COAT AREA = 5,145 sq yds

LEGEND

- ROAD RIGHT-OF-WAY
- - - ROAD CENTERLINE
- PROPOSED ASPHALT-RUBBER CHIP SEAL AREA

CONSTRUCTION LEGEND

1. ASPHALT-RUBBER CHIP SEAL 22' WIDE TRAVEL LANES PER SECTION 37 OF THE PROJECT SPECIFICATIONS. AFTER CHIP SEALING, FLUSH COAT ENTIRE ROAD WIDTH INCLUDING SHOULDERS AND ROAD APRONS.
2. RESTORE EXISTING PAINT STRIPING AND PAINT MARKINGS PER ROAD STRIPING PLAN ON SHEET B10.
3. REPLACE EXISTING ROAD SIGNS PER ROAD SIGN PLAN SHEET B11.

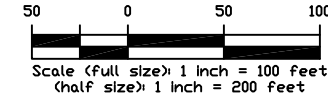

MONO COUNTY PUBLIC WORKS DEPARTMENT			
Rev.#	Date	Revision	
06/24/2019			
Drawing Date: 06/24/2019		Prepared By: CAS	Checked By: GRH

BENTON CROSSING ROAD (PHASE 1)
 ROAD MAINTENANCE PROJECT (NO. 9304-9305)
 BENTON CROSSING ROAD - BID ALTERNATE C
 STA 370+00 TO STA 398+44

SHEET
B9

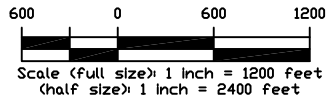

NOTES:

1. PAINT STRIPING AND PAINT MARKINGS SHALL BE RESTORED TO MATCH EXISTING CONDITIONS. CONTRACTOR SHALL ADEQUATELY LOCATE/MARK ALL EXISTING STRIPING LOCATIONS AND TRANSITIONS PRIOR TO BEGINNING CHIP SEALING WORK.
2. LOCATIONS SHOWN HEREON FOR NO-PASSING STRIPING AT CENTERLINE. ALL OTHER LOCATIONS TO RECEIVE SINGLE YELLOW DASHED LINES PER CT STD PLAN A20A, DETAIL 5.
3. 4" WHITE FOG LINES TO BE PLACED AT THE OUTSIDE OF EACH LANE. 12' LANES FROM STA 11+66 TO STA 75+00. 11' LANES FROM STA 75+00 TO STA 385+44. SHOULDER WIDTH SHALL BE 4 FEET TO EDGE OF PAVEMENT.

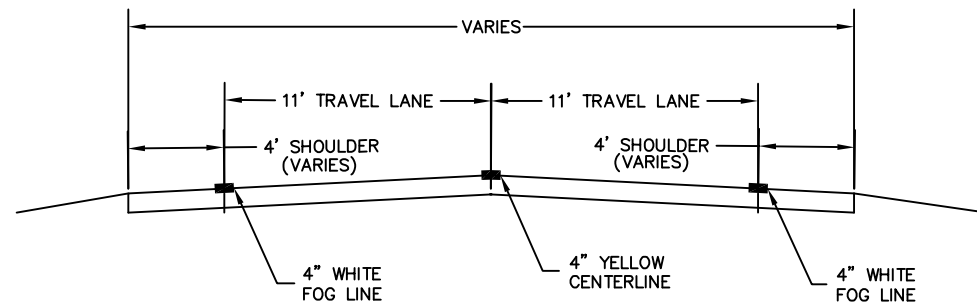
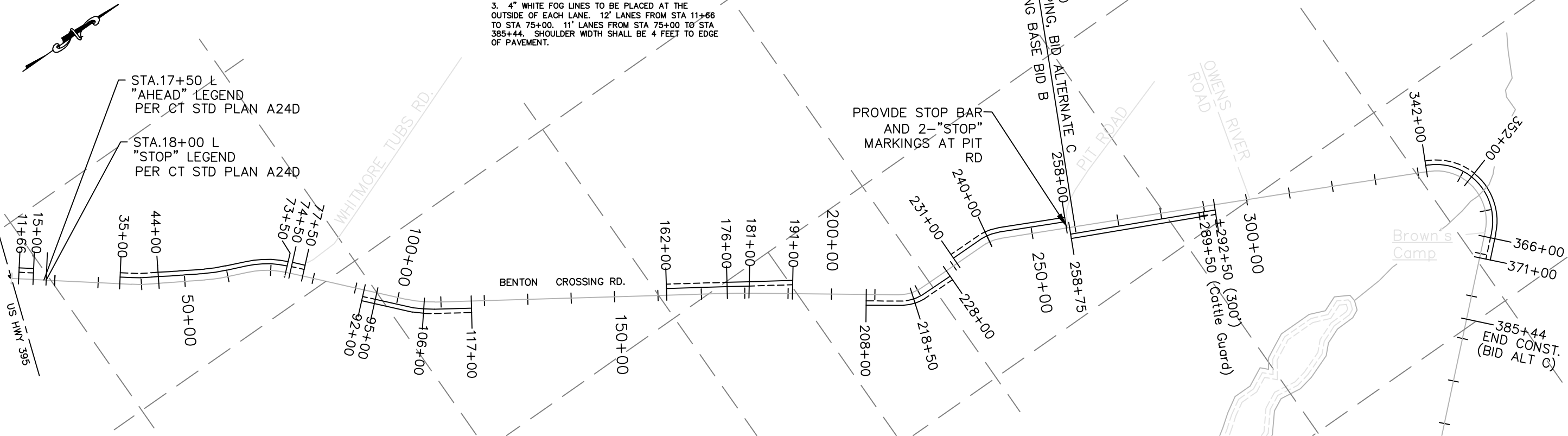

ROAD STRIPING DETAIL

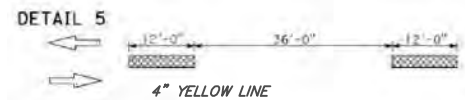

CENTERLINE - PASSING ZONE
CT STD PLAN A20A

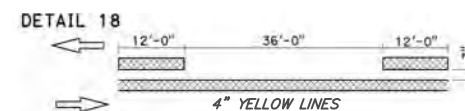

CENTERLINE - PASSING ONE DIRECTION
CT STD PLAN A20A

NO PASSING ZONES-TWO DIRECTION

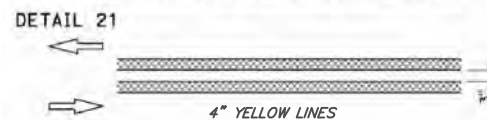

CENTERLINE - NO PASSING ZONE
CT STD PLAN A20A

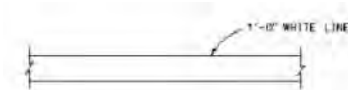

LIMIT LINE (STOP BAR)
CT STD PLAN A24E

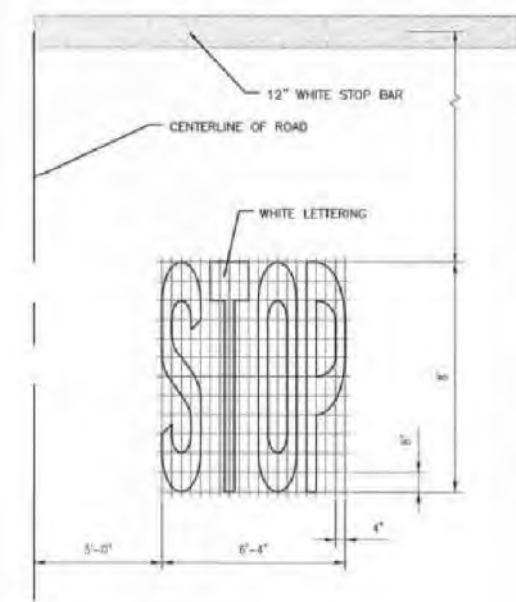

"STOP" MARKING DETAIL
CT STD PLAN A24D



EXP. 6/30/2021

SIGNED:
06/24/2019

MONO COUNTY PUBLIC WORKS DEPARTMENT			
Rev.#	Date	Revision	
06/24/2019		CAS	GRH
Drawing Date: 06/24/2019		Prepared By: CAS	
		Checked By: GRH	

BENTON CROSSING ROAD (PHASE 1)
ROAD MAINTENANCE PROJECT (NO. 9304-9305)
BENTON CROSSING ROAD - ROAD STRIPING PLAN
STA 11+66 TO STA 398+44

SHEET

B10



EXP. 6/30/2021
 SIGNED: 06/24/2019
Janett Hines

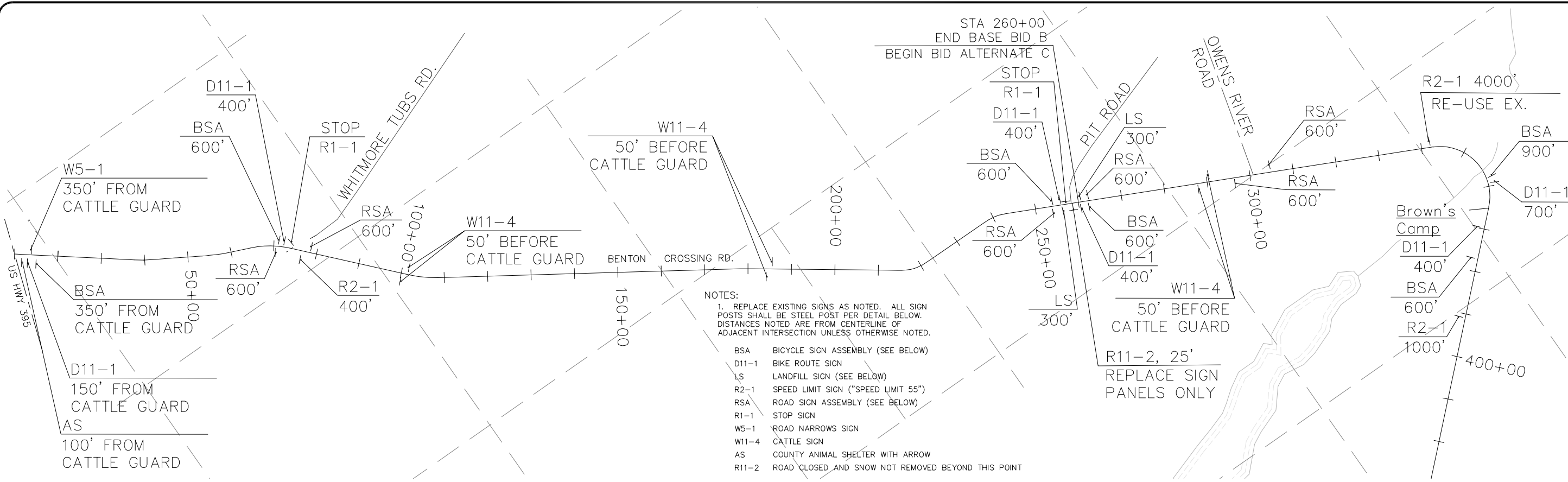

- NOTES:
 1. REPLACE EXISTING SIGNS AS NOTED. ALL SIGN POSTS SHALL BE STEEL POST PER DETAIL BELOW. DISTANCES NOTED ARE FROM CENTERLINE OF ADJACENT INTERSECTION UNLESS OTHERWISE NOTED.
- BSA BICYCLE SIGN ASSEMBLY (SEE BELOW)
 - D11-1 BIKE ROUTE SIGN
 - LS LANDFILL SIGN (SEE BELOW)
 - R2-1 SPEED LIMIT SIGN ("SPEED LIMIT 55")
 - RSA ROAD SIGN ASSEMBLY (SEE BELOW)
 - R1-1 STOP SIGN
 - W5-1 ROAD NARROWS SIGN
 - W11-4 CATTLE SIGN
 - AS COUNTY ANIMAL SHELTER WITH ARROW
 - R11-2 ROAD CLOSED AND SNOW NOT REMOVED BEYOND THIS POINT

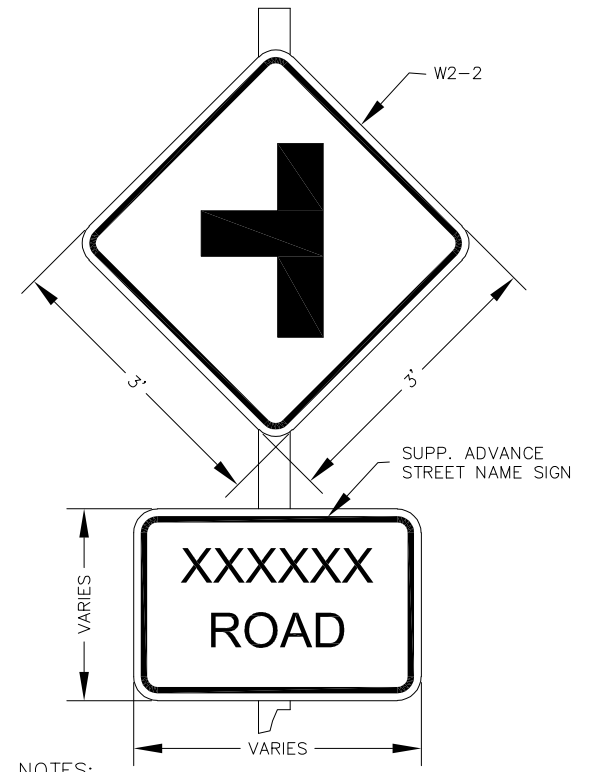

- NOTES:
 1. BLACK LEGEND W/YELLOW BACKGROUND
 2. SIGNS TO BE PLACED AT INTERSECTIONS WITH WHITMORE TUBS ROAD, PIT ROAD, OWENS RIVER ROAD @ 600' FROM INTERSECTION (6 TOTAL).

ROAD SIGN ASSEMBLY

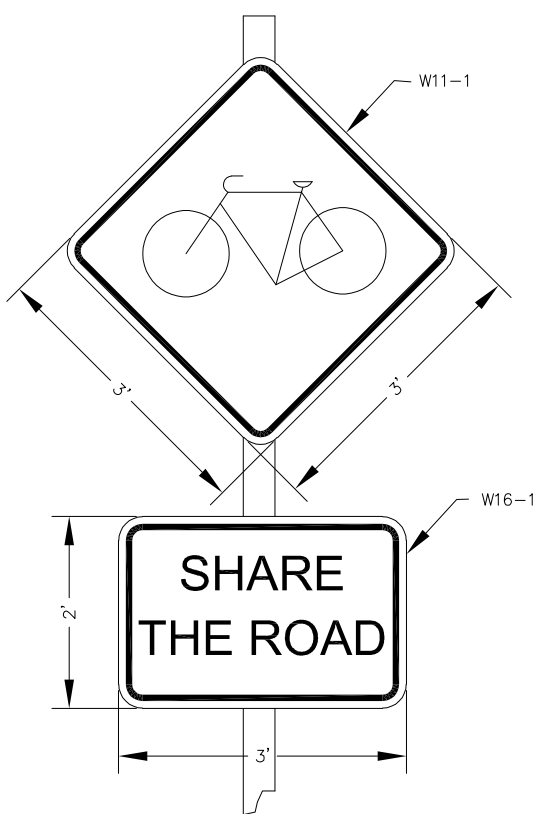

NOTE: BLACK LEGEND ON YELLOW BACKGROUND

BICYCLE SIGN ASSEMBLY

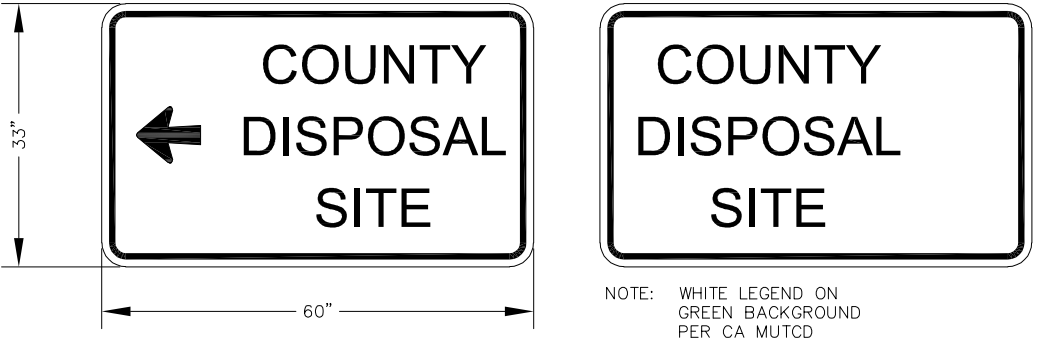

NOTE: WHITE LEGEND ON GREEN BACKGROUND PER CA MUTCD

LANDFILL SIGNS

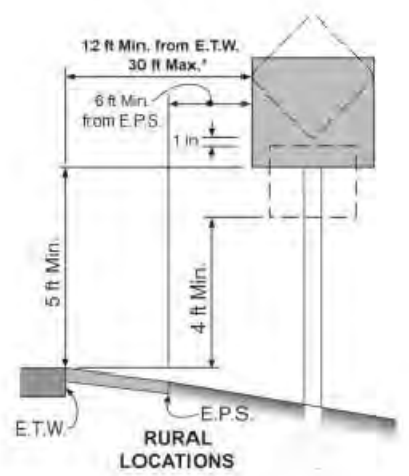

ROADWAY SIGN PLACEMENT DETAIL
 CA MUTCD
 NOT TO SCALE

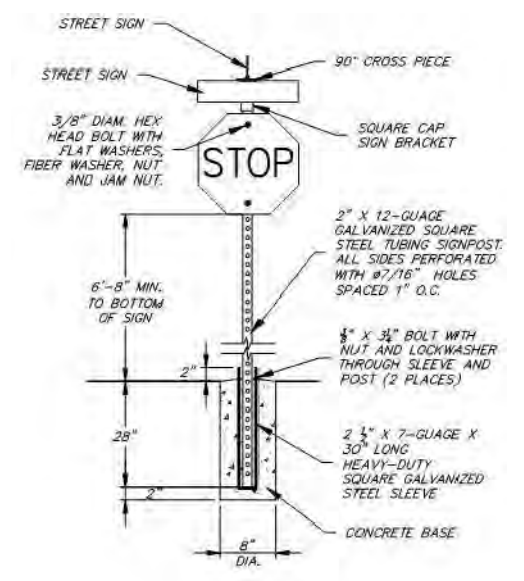

- NOTES:
 1. SIGN MATERIALS, CONSTRUCTION AND PLACEMENT SHALL BE IN CONFORMANCE WITH THE LATEST EDITION OF THE CALIFORNIA MANUAL OF UNIFORM TRAFFIC CONTROL DEVICES.
 2. SIGNS SHALL BE MOUNTED WITH TAMPER PROOF HARDWARE.

STEEL-POST ROAD SIGN DETAIL
 NOT TO SCALE

MONO COUNTY PUBLIC WORKS DEPARTMENT

Revision	
Drawing Date: 06/24/2019	Rev.#
Prepared By:	
Checked By:	

BENTON CROSSING ROAD (PHASE 1)
 ROAD MAINTENANCE PROJECT (NO. 9304-9305)
 BENTON CROSSING ROAD - ROAD SIGN PLAN
 STA 11+66 TO STA 398+44